

RFQ No. 0006/2011

RFQ for Engaging MSP for Biometric Enrolment
for the Creation of NPR for Usual Residents of
Rural Areas in 17 States and 1 UT in India

Ref. No.: DOACH/20-36/2011/

Cost of RFQ: Rs. 25000/-
(Rupees Twenty Five Thousand Only)

DOEACC SOCIETY
AN AUTONOMOUS SCIENTIFIC SOCIETY
OF
DEPARTMENT OF INFORMATION TECHNOLOGY,
MINISTRY OF COMMUNICATIONS & INFORMATION TECHNOLOGY,
GOVERNMENT OF INDIA
6 CGO COMPLEX, ELECTRONICS NIKETAN, NEW DELHI-110003



डी ओ ई ए सी सी

**REQUEST FOR QUOTATION (RFQ)
FOR
ENGAGING MANAGED BIOMETRIC ENROLLMENT
SERVICES
FOR
THE CREATION OF NATIONAL POPULATION REGISTER
(NPR) FOR USUAL RESIDENTS IN RURAL AREAS
OF 17 STATES AND 1 UT in INDIA**

Date of Issue	Issued To (Name & Address)	Payment Details			Signature of Issuing person
		DD No. and Date	Name of the Bank and Branch	Amount (Rs.)	

Table of Contents

<u>Section</u>	<u>Contents</u>	<u>Page No.</u>
1.	Invitation to bid	3
2.	INTRODUCTION	12
3.	SCOPE OF SERVICES	15
4.	SCHEME FOR WORK ALLOCATION	19
5.	PAYMENT TERMS	21
6.	PERFORMANCE MANAGEMENT	22
7.	BID OPENING AND EVALUATION	24
8.	Instruction to Bidders	25
	ANNEXURE 1.....	30
	Format of Letter of Intent to submit bid in response to RFQ Invitation.....	30
	ANNEXURE 2.....	32
	Format of Financial Bid.....	32
	ANNEXURE 3.....	33
	Format of Performance Bank Guarantee (PBG).....	33
	ANNEXURE 4.....	36
	Conditions of Managed Biometric Enrolment Services Contract	36
	ANNEXURE 5.....	43
	ANNEXURE 6.....	53
	Zone wise EMD Amount.....	53
	ANNEXURE 7.....	55
	Tentative Detailed Scope & Plan for Biometric Enrollment Services	55
	ANNEXURE 8.....	61
	Format for Project Implementation Plan.....	61

1. INVITATION TO BID

This “invitation to bid” is for providing managed biometric enrolment services for the creation of national population register (NPR) for usual residents of Rural Areas of assigned 17 States and 1 UT.

The organizations (single agencies / consortiums) which have already been empanelled by Unique Identification Authority of India (UIDAI) as “enrolling agencies” for undertaking demographic and biometric data collection for enrolment of residents are eligible to bid. The list of such agencies is available at <http://uidai.gov.in>.

1.1. RFQ to Pre-Qualified Bidders

Date: DD-MM-YYYY

To,

1. DOEACC Society (hereinafter called “the Purchaser”) invites Financial Bids from pre-qualified bidders for “**Providing Managed Biometric Enrolment Services for the Creation of National Population Register (NPR) for Usual Residents in Rural Areas in India**” in 17 States and 1 Union Territory. The detailed scope of work for this assignment is provided in **Section 3 – Scope of Services**.
2. The selected bidder(s) will be called “Managed Service Provider (MSP)” for the purpose of this RFQ and for the whole duration of the contract thereof or till the selected bidder is fully discharged from his obligations under this project, by purchaser, whichever is later.
3. All pre-qualified bidders have to submit only the “Financial Bid(s)” corresponding to the **71 zones** as mentioned in this RFQ. Each Bidder must submit a single bid and provide quotes for individual Zones based on the eligibility criteria prescribed in this RFQ.
4. This “Invitation to Bid” is only to the organizations (single agencies/consortiums) which have already been empanelled by Unique Identification Authority of India (UIDAI) as “Enrolling Agencies” for undertaking demographic and biometric data collection for enrolment of residents. The list of such agencies is available at <http://uidai.gov.in>.
5. In addition to the terms and conditions herein all the provisions listed out in the “Request for Empanelment (RFE)” issued by the UIDAI and the terms & conditions of Empanelment shall be binding upon the UIDAI empanelled “Enrolling Agencies” participating as bidders for this RFQ.
6. This RFQ document shall be issued only to the above-mentioned pre-qualified bidders and is non-transferable/assignable. The notice regarding issue of this RFQ will be sent by email to the authorized contact person of the pre-qualified bidders

and will also be published on the website of the Purchaser (mit.gov.in, doeaccchd.edu.in, doeacc.edu.in). Notice regarding issue of this RFQ will also be published in two national news papers and the Indian Trade Journal, Kolkata.

7. Any subsequent corrigenda/clarifications related to this RFQ will be published on the website of the Purchaser at mit.gov.in, doeaccchd.edu.in and doeacc.edu.in. All such subsequent corrigenda / clarifications shall be binding on the bidders.
8. Pre-qualified bidders are advised to study this RFQ document carefully before submitting their financial bids in response to the bid Invitation. Submission of a financial bid in response to this invitation shall be deemed to have been done after careful study and examination of this document with full understanding of its terms, conditions and implications.
9. Pre-qualified bidders will need to submit their Financial Bid – in sealed envelope, at the address mentioned under **Section 1.2. “Important Information”**. The formats for Submission of Bids have been given in the relevant sections in this document and shall be followed by pre-qualified bidder.
10. The Purchaser is not bound to accept any bids, and at its sole discretion reserves the right to annul the selection process at any time prior to the award of contract without assigning any reasons whatsoever and without thereby incurring any liability to the bidders.

11. RFQ Document Fees:

The pre-qualified bidders shall pay Rs 25,000/- (Rupees Twenty Five Thousands only) in the form of a Demand Draft issued by a nationalized/scheduled commercial bank, drawn in favour of **“The Director, DOEACC Society, Chandigarh Centre”** payable at Chandigarh. This fee is non-refundable and shall be submitted along with the response to this RFQ to the Purchaser. The payment of Rs 25000/- shall be the condition precedent for submitting the bids.

12. Earnest Money Deposit (EMD)

- (i) All bids submitted in response to this RFQ document shall accompanied by Earnest Money Deposit (EMD). Please refer **Annexure-6** for zone wise **EMD amounts** in the form of Demand Draft issued by a nationalized bank, drawn in favour of “The Director, DOEACC Society, Chandigarh” payable at Chandigarh. Bidders bidding for multiple zones need to submit a single EMD for the total cumulative amount.
- (ii) Forfeiture of Earnest Money Deposit (EMD)
The EMD submitted along with the bid shall be forfeited under the following conditions:
 - a. If the bid is withdrawn during the validity period or any extension agreed to by the Bidder thereof.
 - b. If the bid is varied or modified in a manner not acceptable to the Purchaser after opening of Bid during the validity period or any extended thereof.
 - c. If the Bidder tries to influence the evaluation process.
 - d. If the Bidder does not accept the correction of errors in his bid.

- e. If the bidder is successful and fails to sign the Contract within the time stipulated by the Purchaser.
- f. If the Bidder refuses to take up the job in the assigned zone within the time stipulated by the purchaser.
- g. If the Bidder, having been notified of his selection, fails or refuses to submit the required Performance Bank Guarantee within the time stipulated by the Purchaser.

(iii) Refund of EMD

The EMD will be refunded as follows:

- a. In the case of unsuccessful bidders, the EMD will be returned to them without any interest accrued thereon at the earliest after the award of the contract to the successful bidders..
- b. In the case of selected bidder(s), the EMD shall be refunded on receipt of the Performance Bank Guarantee.

1.2. Important Information

S. NO.	Information	Details
1.	Name of the purchaser	DOEACC Society
2.	Date of Issue of RFQ Document	15.09.2011
3.	Last date for Submission of Queries	23.09.2011
4.	Response to Queries and Pre-Bid Conference	3:00 PM on 29.09.2011 at SCOPE, CORE 8, 1st FLOOR, "SCOPE COMPLEX", 7 LODHI ROAD, NEW DELHI 110003
5.	Last date and time for Bid submission	28.10.2011 by 5.00 PM
6.	Date and Time for opening of Bids	01-11-2011 & 02-11-2011 at 11:00 AM
7.	Contact Person for queries	The Project Co-ordinator, DOEACC SOCIETY, Chandigarh Centre SCO 114-116, Sector 17B, Chandigarh – 160017. Tel: 0172-2702262/2702265/2703285 Email: dir_chd@doeacc.edu.in
8.	Addressee and Address at which bids in response to RFQ Invitation are to be submitted	The Director, DOEACC Society, Chandigarh Centre, Branch Office New Delhi, 2nd Floor, Parsavnath Metro Mall, Inderlok Metro Station, Delhi - 110035

1.3. General Eligibility Criteria

- 1.3.1. Only those organizations/ consortia will be eligible to bid for this RFQ which have already been empanelled by the Unique Identification Authority of India (UIDAI) as “Enrolling Agencies” for undertaking demographic and biometric data collection for enrolment of usual residents in India. The list of such agencies is available at <http://uidai.gov.in>
- 1.3.2. The pre-qualified agencies, which are empanelled with UIDAI (as mentioned under Para 1.3.1), will be eligible to bid for only those zones in this RFQ which are in States/UT in respect to which they have been empanelled by UIDAI for undertaking demographic and biometric data collection for enrolment of residents,
- 1.3.3. Consortium: Those Consortia which are empanelled by UIDAI.
- 1.3.4. In case of a Consortium (as mentioned under Para 1.3.3), only a pre-qualified single agency (as mentioned under Para 1.3.1) must act as the Lead Bidder and shall be solely responsible to the Purchaser for executing the activities enlisted in this RFQ and the contractual obligations, if selected for carrying out these activities. The Lead Bidder shall submit the Financial Bid on behalf of the Consortium.
- 1.3.5. Agencies bidding as part of a consortium (as mentioned under Para 1.3.1 and Para 1.3.3) cannot bid in individual capacity.
- 1.3.6. The Bidder i.e. legally registered / established and operative (single agency/all consortium members) should have been in existence for a period of at least 3 years as of 31-March-2011.
- 1.3.7. The Bidder (single agency/all consortium members) must be incorporated or registered in India under the Indian Companies Act, 1956 (including Section – 25 of the Act) OR the Partnership Act, 1932 OR Societies Registration Act 1860 OR the Indian Trusts Act 1882/its equivalent in the respective states OR Proprietorship entities having a PAN of Income Tax the Income-tax department, Govt of India.
- 1.3.8. The Bidder in case of Private/PSU/Govt. Company/Commercial Organization/Autonomous Body (single agency/Lead Bidder in case of a consortium) should have a Net Worth of at least Rs. 50 lakhs as of 31-March-2011 as evidenced by the audited accounts of the organization.

- 1.3.9. The Bidder in case of NGOs/Not-for-Profit organization (single agency/Lead Bidder in case of a consortium) should have had an average annual turnover/grants-in-aid of at least Rs 50 lakhs in each of the last three financial years as evidenced by the audited accounts. In addition, those NGOs/Not-for-Profit organizations that are receiving grants/aid from foreign sources must hold a valid registration with the Ministry of Home Affairs, Government of India. The NGO/ Not-for-Profit organization must be a non-political and nondenominational organization with no affiliation to any political party or religion.
- 1.3.10. In case of a Consortium, the Net Worth (in case of Private/PSU/Govt. Company/Commercial Organization/Autonomous Body) of the Average Annual Turnover/Grant-in-aid (in case of NGOs/Not-for-Profit organization) of only the Lead Bidder will be considered for the purposes of evaluating the financial capability and allocating zones to the Bidder.
- 1.3.11. The Bidder (single agency/all consortium members) should not have been blacklisted by the Central, any State/UT Government, or any central or state Government agency as on the date of issue of this RFQ or during the subsequent bid processing and evaluation.
- 1.3.12. Only those Bidders who meet the eligibility criteria specified above will be eligible to respond to this RFQ. The Bidder's bid shall contain the relevant information and supporting documents (as specified in Section 1.4 below against each criteria) to substantiate the eligibility of the Bidder vis-à-vis the pre-qualification criteria.
- 1.3.13. All Consortium members including Lead bidder shall be jointly and individually responsible and liable to the Purchaser who shall have exclusive right to demand performance / payments / compensation in full or in part from any one or more or all the members of consortium.

1.4. Mandatory List of Documents to be Submitted

- 1.4.1. Certified true copies of certificate of Incorporation from the Registrar of Companies (RoC) or certified copy of Certificate of Registration/Evidence of legal status of Bidder (Single Agency/all Consortium members).

- 1.4.2. True copy of Letter of Association in case of Consortium and certified true copy of the Consortium agreement between the Lead Bidder and the other members of the consortium, describing the respective roles and responsibilities of all the members in meeting the overall scope and requirements of this RFQ/project.
- 1.4.3. Audited and certified financial statements for the financial years 2008-09, 2009-10 and 2010-11 (please include the sections on Profit & Loss (P&L)/Income and Expenditure, Turnover, and Assets and Liabilities) should be provided by all types of Bidders. In addition, an Auditor's certificate specifying the Net Worth and Turnover/Grants-in-aid of the Organization as of 31-March-2011 should be provided by all types of Bidders.
- 1.4.4. True copy of valid registration certificate from the Ministry of Home Affairs, Government of India for those NGOs/Not-for-Profit organizations that are receiving grants/aid from foreign sources.
- 1.4.5. Declaration in form of affidavit by the President/CEO/CMD of the organization clearly stating that the organization has not been blacklisted by Central/State/UT Government or any Government agency and has not been charged/ prosecuted by court of law for any fraudulent activity.
- 1.4.6. Proof for Organization's PAN of Income tax and VAT/Service Tax number.
- 1.4.7. Profile of the Organization giving relevant details of nature of work, experience, infrastructure, resources turnover, Profit & Loss etc.
- 1.4.8. Letter of Empanelment issued by UIDAI clearly stating that the organization (single agency/consortium as mentioned under Para 1.3.1 or the Lead Bidder in case of Consortium as mentioned under Para 1.3.3) is empanelled with UIDAI as an "Enrolling Agency" and indicating the technical and financial tier of the organization as assessed by UIDAI.; also indicating the States and UT for which the organization has been empanelled by UIDAI.
- 1.4.9. A Project Implementation Plan as per the format provided at Annexure 8 detailing how the bidder plans to implement the project in the zones that it is bidding.

1.5. Definitions and Acronyms

1. **Accounting Year** – shall mean the financial year commencing from 1st April of any calendar year and ending on 31st March of the next calendar year. In case of a global company, the commencement date and ending date should be read as 1st January and 31st December respectively of the calendar year.
2. **BG** – Bank Guarantee.
3. **Bid** – Bid means the entire set of documents including the financial bid or proposal that have been submitted by the bidders in response to this RFQ. A “Proposal” is referred to as “Bid” in this RFQ and shall have the same meaning for the purposes of this RFQ unless otherwise specified.
4. **Bidder** – Shall mean either a single company or a consortium of not more than three (3) companies participating in this bidding process. The bidder should **mandatorily** have relevant and demonstrable experience in biometric enrollment projects. Bidder shall be pre-qualified bidder means enrolled as an enrolling agency with UIDAI as mentioned in 1.3 above.
5. **Biometric Data** – refers to the facial image, Iris Scan of both eyes and 10 fingerprints collected by the Enrolment Agency from the enrollees based on the standards prescribed by the UIDAI.
6. **Consortium** – The consortium empanelled with UIDAI as an Enrolling Agency.
7. **CPSU** – Consortium of Public Sector Undertakings.
8. **De-duplication** – the process of using the Demographic and Biometric data collected from an enrollee to check against data so as to avoid duplicate enrolments.
9. **Demographic Data** – refers to the personal information collected or verified by the Census Enumerators based on the data fields prescribed by the Registrar General of India (RGI) for the NPR Schedules and by following the process laid down for the purpose.
10. **DIT** – Department of Information Technology, Ministry of Communications & Information Technology, Government of India.
11. **DOEACC** – DOEACC is an Autonomous Scientific Society under DIT, Ministry of Communications & Information Technology, Government of India, involved in large scale data processing, training (corporate, government & individual), consultancy, product development, entrepreneurship development & HRD in Information, Electronics & Communication Technologies. It has a network of centres in India.
12. **EMD** – Earnest Money Deposit.
13. **Enroller**- Certified and trained person employed by the MSP and engaged in the biometric enrolment of resident.

14. **Enrolling Agency/ Enrolling Agencies** – The Agency/Agencies empanelled by UIDAI for undertaking demographic and biometric data collection for and recording in prescribed manner thereof for enrolment of residents.
15. **Enrolment** – refers to the exercise of collection and recording in prescribed manner thereof of demographic as well as biometric data of the usual residents of India.
16. **GOI** – Government of India.
17. **ICR**- Intelligent Character Recognition Software and ICR Software shall mean Intelligent Character Recognition Software.
18. **Lead Bidder** – shall mean the member of consortium which shall act as the sole interface with the Purchaser on behalf of the consortium, contractually and for other interactions, and who shall be responsible for successful execution of the project including support and maintenance activities if any for / after the entire agreement period and in accordance with any surviving provisions thereof. The lead bidder should have relevant and demonstrable experience in biometric enrollment projects.
19. **LoI** – Letter of Intent.
20. **LRUR**- Local Register of Usual Residents
21. **MIS** – Management Information System. An online MIS tool shall be developed and provided by The Purchaser or any other agency on its behalf for supervision and monitoring of the entire process of demographic data digitization, biometric enrollment and LRUR printing by the MSPs.
22. **MSP** – Managed Service Provider. This will be the selected bidder which will provide Biometric Enrollment Services for capturing of biometric data of usual residents.
23. **Net Worth** –Net Worth shall mean (Subscribed and Paid-up Equity + Reserves) less (Revaluation reserves + miscellaneous expenditure not written off + accrued liabilities).
24. **NeGP** – National e-Governance Plan
25. **NGO** – Non Non Government Organization registered with Ministry of Home Affairs, Government of India.
26. **NPR** – National Population Register.
27. **Operator** – Certified and trained person employed by the MSP and engaged in the digitization of demographic data
28. **Operational Partner** – Member of Consortium having proven experience in Project Operations / Training / Logistics / supply chain management.
29. **ORG&CCI** – Office of the Registrar General and Census Commissioner, India.
30. **PBG** – Performance Bank Guarantee.
31. **Period of Contract** – 2 years from the date of award of contract with the selected bidder(s), which may be extended by the Purchaser depending upon the nature of work.
32. **PoA** – Power of Attorney.

33. **Pre-qualified Bidders** – All Bidders which have been selected by UIDAI as “Enrolling Agencies” for undertaking demographic and biometric data collection for enrolment of residents.
34. **Proposal:** Proposal means the entire set of documents including the financial proposal that have been submitted by the bidders in response to this RFQ. A “Proposal” is referred to “Bid” in this RFQ and shall have the same meaning for the purposes of this RFQ unless otherwise specified.
35. **Purchaser** - “Purchaser” means the entity with which the selected Bidder signs the Contract for the Services. In this RFQ and for the purposes of this project, the ‘Purchaser’ means the ‘DOEACC Society’.
36. **Record** - refers to the personal information collected or verified for each person by the Census Enumerators based on the data fields prescribed by the Registrar General of India (RGI) for the NPR Schedules and by following the process laid down for the purpose.
37. **Resident** – Usual resident of India.
38. **RFQ** – Request for Quotation.
39. **RGI** – Registrar General of India
40. **SLA** – Service Level Agreement.
41. **UID** – Unique Identification.
42. **UIDAI** – Unique Identification Authority of India.
43. **UT** – Union Territory.

2. INTRODUCTION

2.1. Background - Indian Census and National Population Register (NPR)

The Government of India has initiated the creation of Digitized National Population Register (NPR) by collecting specific information of all usual residents in the country during the House listing and Housing Census phase of Census 2011 during April 2010 to September 2010. The NPR is a comprehensive identity database to be maintained by the Registrar General and Census Commissioner of India, Ministry of Home Affairs, Government of India (RGI). The objective of creation of the NPR is to help in better utilization and implementation of the benefits and services under the government schemes, improve planning, improve security and prevent identity fraud.

PROCESS OF CREATION OF NPR

In the NPR process, following details are being gathered by designated enumerators by visiting each and every household:

- i. Name of the person in full and residential Status
- ii. Name of the person as should appear in National Population Register
- iii. Relationship to Head
- iv. Sex
- v. Date of Birth
- vi. Marital Status
- vii. Educational Qualification
- viii. Occupation/Activity
- ix. Name(s) of father, mother and spouse in full
- x. Place of Birth
- xi. Nationality as declared
- xii. Present address of usual residence
- xiii. Duration of stay at present address
- xiv. Permanent residential address

A specimen scanned copy of the NPR schedule is available for download from Census of India website at:

<http://www.censusindia.gov.in/2011-Schedule/Index.html>

The data thus collected will then be digitized in the local language of the State as well as in English. This digitization involves the scanning of the forms (NPR Schedules) and validating the data using an Intelligent Character Recognition Software (ICR). For this purpose, RGI has established a number of scanning centres across the country. The data thus stored in the form of scanned images will then be manually digitized.

Once this demographic database has been created, then the biometrics enrolment (capture of 1 Photograph, 10 Finger Prints and Iris scan of both eyes) will be carried out for all persons aged 5 years and above by arranging enrolment camps in every village and at the ward level in every town. The collected data will be printed in the form of LRUR (Local Register of Usual Residents) and displayed at prominent places within the village and ward for the public to see and raise objections and complaints. Objections will be sought and registered at this stage. Each of these objections will then be enquired into by the local Revenue Department Officer/ Census Department Officer/ Municipal Commissioner and a proper disposal given in writing. Once this process is over, the lists will be placed in the Gram Sabha in villages and the Ward Committee in towns. Claims and Objections will be received at this stage also and dealt with in the same manner described above. The Gram Sabha/Ward Committee has to give its clearance or objection within a fixed period of time after which it will be deemed that the lists have been cleared.

The information thus authenticated will then be sent to the UIDAI for de-duplication and issue of Unique Identification (UID) Numbers. The cleaned database along with the UID Number will then be sent back to the Office of the Registrar General and Census Commissioner, India (ORG&CCI) and would form the National Population Register. The diagram below shows the entire process of NPR in a nutshell.

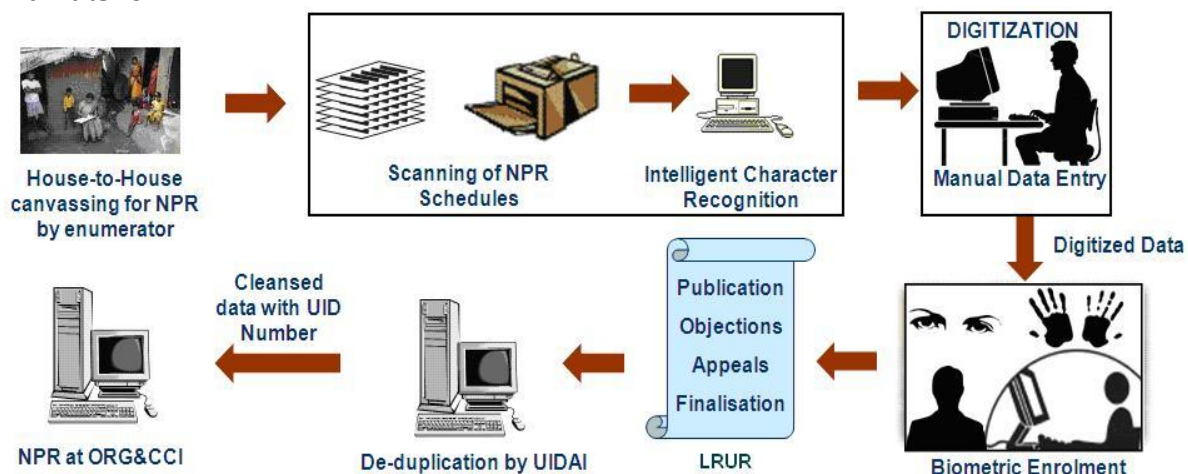

METHODOLOGY FOR NPR CREATION

The RGI, MHA has entrusted the work of demographic data digitization and bio-metric collection in respect of 17 States and 2 UTs to the Department of Information Technology. The Department of IT is spearheading the digitization process and envisages the participation of its societies -DOEACC, STPI and C-DAC in this project. DOEACC Society has been made Nodal Agency by DIT for implementation of the project. It is estimated that the project will digitize the data of about 62.5 crore population of India and biometric capture of about 56.2 crore people. Biometric includes photograph, all ten finger prints and Iris capture for the population above 5 years age. The digitization of NPR will be done in 6 months. The Biometric capture will be done in 1 year.

2.2. Role of Department of Information Technology (DIT) in NPR

The Office of the Registrar General and Census Commissioner, India (ORG&CCI) has assigned Department of Information Technology (DIT) the responsibility of demographic data digitization and biometric data collection in 17 States and 2 Union Territories of India. .

DIT will undertake the following activities on behalf of the ORG&CCI to enable creation of the National Population Register and facilitate the issuance of UID number to the residents within the states assigned to DIT:

- **Digitization:** The ORG&CCI will be responsible for scanning and Intelligent Character Recognition (ICR) of schedules collected from the field. Once ICR has been performed, the scanned images will be handed over to DIT to complete manual data entry in two languages, i.e. English Language and Local Language of the State.
- **Biometric Enrolment:** Upon completion of manual data entry, DIT will capture biometric data of all residents aged 5 years and above.
- **Data Consolidation and Delivery:** DIT shall consolidate the captured data, including demographic and biometric data, and deliver the same to ORG&CCI for further de-duplication and assignment of UID number by the UIDAI.

DIT recognizes that this assignment calls for organizations which have demonstrable experience in demographic data digitization and enrolment and also requires significant financial commitments from them in order to successfully execute it within the stipulated time schedule.

2.3. Role of DOEACC Society

DOEACC Society, an autonomous Scientific Society of the Department of Information Technology, Ministry of Communications and Information Technology, Government of India has presence at 23 locations throughout the country having its Headquarter at New Delhi. The Society has immense capabilities for execution of e-Governance Projects.

For the purpose of ensuring complete coverage of the 17 States and 1 UT, DIT plans to divide the work of demographic data digitization and biometric data collection into urban and rural areas. DIT intends to leverage the network of DOEACC Society which has been designated as nodal agency for implementation of NPR Project. The overall responsibility for completing the work of Demographic Data Digitization & Biometric Enrolment of the assigned States/UT in the urban and rural areas has been delegated to DOEACC Society by DIT.

3. SCOPE OF SERVICES

The MSP(s) shall provide end-to-end Managed Biometric Enrollment Services to the Purchaser for the purpose of capturing Biometric Data (Face Photograph, Iris of both the eyes and Ten Fingers of both hands) for the usual rural Residents of India in 17 States and 1 UT. There are 71 rural zones in 17 States and 1 UT where NPR activities have to be carried out by DOEACC Society.

The population coverage for this work is approximately 49.5 crore (estimation based on 2001 census data Annexure-5.) usual residents of the rural population in the following 17 States and 1 Union Territory of India.

List of States:

1. Arunachal Pradesh
2. Assam
1. Bihar
2. Chattisgarh
3. Haryana
4. Himachal Pradesh
5. Jammu & Kashmir
6. Jharkhand
7. Madhya Pradesh

10. Meghalaya

11. Mizoram

12. Punjab

13. Rajasthan

14. Sikkim

15. Tripura

16. Uttar Pradesh

17. Uttarakhand

List of Union Territory:

1. Dadra & Nagar Haveli

- The Biometric Enrollment needs to be performed for 100% rural resident population having age above 5 years of these 17 States and 1 UT.
- In order to achieve above mentioned objectives, the 17 States and 1 UT have been classified into 71 zones. The composition of the 71 and their estimated population is provided at **Annexure- 5**.
- The Purchaser may select one or more successful bidders (single bidders or consortiums) to execute the project. The Work Allocation Scheme is explained in detail in **Section 4 – Scheme for Work Allocation**. The Evaluation Procedure is explained in detail in **Section 7 – Proposal Opening and Evaluation**.
- The selected MSP(s) shall commence work within 30 days of award of contract. The work of data entry should be completed within 12 months starting from the 31st day after the award of contract. The overall duration of project will be of 2 years.
- **The responsibilities of the MSP(selected bidder(s)) will include the following:**
 - i. Based on the volume of work, allocated as per the bidding process, the MSP have to **procure/hire biometric devices** as per UIDAI norms/specifications. The set of devices for Biometric Enrollment include atleast:

- Laptop
 - Digital Camera
 - Finger print scanner
 - Iris Scanner
 - Printer
 - One additional screen facing enrollee
 - Other Requirements (if any) as per UIDAI
- ii. Based on the volume of work, to set up camps in villages with necessary infrastructure at various locations as and when desired by the Purchaser in coordination with Local District Authorities.
 - iii. The capturing of biometric data as per UIDAI norms is the prime responsibility of the Bidder.
 - iv. There must be camp supervisor to ensure smooth functioning of camps.
 - v. Selected MSP(s) to receive digitized data of NPR schedules from the State coordinator of Purchaser and perform the Biometric Enrollment as per instruction of the Purchaser.
 - vi. Selected MSP(s) to obtain the Biometric Enrollment software from The Purchaser and ensure installation of the software at all biometric capturing camps.
 - vii. Ownership of the biometric Software shall vest exclusively with the RGI. MSP shall use such biometric capturing Software only for the purpose of biometric capture which is assigned by the Purchaser. MSP shall be responsible and liable for legal actions and damages if it does any act (e.g. copying, duplicating software etc.) or omission other than enrollment assignment.
 - viii. Ensure Biometric Enrollment using the software received from The Purchaser and perform its installation.
 - ix. To capture KYR+ files in addition to Biometric Capture as suggested by RGI, will be captured through KYR+ software.
 - x. Update/Edit/Modify the digitized demographic data (if required).
 - xi. Printing of Acknowledgement Slip for each biometric capture/enrolment.
 - xii. Selected MSP(s) shall arrange at least two rounds of Biometric Camps in a locality. If the Biometric Capture is not enough (less than 90%), MSP shall arrange additional camps at Taluk Office to meet the target at their expense.
 - xiii. The purchaser will provide the required training at locations to be specified by them free of cost to five (5) Master Trainers from each MSP selected after the bidding process. However a fixed charge of Rs. 500 per person shall be recovered by the Purchaser from the selected agencies for providing training material etc.

- xiv. On satisfactory conclusion of training, a certificate of participation shall be provided by the Purchaser to each successful participant. However, the master trainer must get certified by a UIDAI certifying agency.
- xv. These Master Trainers of MSP are expected to, in turn, train their operators supervisors, assistants etc involved in the process of enrollment.
- xvi. Training of own personnel on the biometric capturing software as well as on the overall process and procedures with the help of training material provided by the Purchaser.
- xvii. MSPs should engage enrollers only after they have been trained and certified for enrollment.
- xviii. Ensure Biometric Enrollment through UIDAI Certified manpower.
- xix. Ensure the Biometric Enrollment as per guidelines provided by UIDAI/RGI.
- xx. Proper checking and verification of Captured Biometric data.
- xxi. Ensure regular backup of captured data over an external media as prescribed in the project implementation plan.
- xxii. Provide data into an external media in the form prescribed by the Purchaser.
- xxiii. Printing of 4 Copies of LRUR. Each LRUR page will have seven records.
- xxiv. Provide necessary assistance to data digitizing agency in correction of LRUR.
- xxv. Submit the complete and corrected data to DOEACC as per the timelines prescribed by DOEACC.
- xxvi. Ensure Interim storage management of complete data and ensure secure transfer of data from the camp to Purchaser's designated locations of data collection.
- xxvii. Ensure interim storage management and complete security of data captured.
- xxviii. Ensure MIS reporting of the complete work on a daily basis through the MIS tool provided by the Purchaser.
- xxix. Report in the prescribed formats, the progress of the biometric capturing work and other activities related to the project in writing to the Purchaser on a weekly basis.
- xxx. Ensure complete security of the data provided and captured at all the stages and at times before, during and after entire operation.
- xxxi. Prevent any unauthorized access to the data provided and the biometric captured at all stages at all the times before, during and after the entire operation.

- xxxii. Ensure that software and data captured /contained are at all times kept secured and free from viruses/ unauthorized access/ copying /editing/ transmitting/storing / carrying etc.
- xxxiii. Bidders acknowledge and accept that they shall not be entitled to any extra compensation /remuneration/ reimbursement / fees/ payments other than quoted rate, on account of (or for overcoming) difficulties / problems. It shall be the sole responsibility of bidder to complete the entire entrusted work with quality and in time.

In order for the MSP(s) to effectively execute the above mentioned services, the Purchaser with help of RGI will provide all assistance and support in terms of identification and availability of Government Agencies required for these services, e.g. Local governing bodies at each level - Central/State/District/Tehsil/Village, Physical security wherever necessary using State Police/Paramilitary forces etc. The tentative detailed methodology for Biometric Enrollment is attached as **Annexure 7**.

4. SCHEME FOR WORK ALLOCATION

The Purchaser also recognizes that managed service provisioning requires significant financial commitments over an extended period of time and this would require a matching revenue assurance from the parties willing to make such commitments.

All pre-qualified bidders shall submit their Financial Bids [Price per biometric enrolment per person] for each zone they are bidding for and provide individual quote. All pre-qualified bidders will be classified into four tiers of financial capability as follows:

Commercial Organizations (Single Bidder/Lead Bidder in case of a Consortium)		NGOs/Not-for-profit Organizations (Single Bidder/Lead Bidder in case of a Consortium)	
Net Worth (as on 31 st March 2011)	Tier	Annual Turnover/Grants-in-aid (as on 31 st March 2011)	Tier
Rs 50 Lakhs to Rs 2 Crores	NW1	Rs 50 Lakhs to Rs 2 Crores	NW1
Rs 2 Crores to Rs 5 Crores	NW2	Rs 2 Crores to Rs 5 Crores	NW2
Rs 5 Crores to Rs 20 Crores	NW3	Rs 5 Crores to Rs 20 Crores	NW3
More than Rs 20 Crores	NW4	More than Rs 20 Crores	NW4

In case of those bidders which are empanelled with UIDAI as Enrolling Agencies, the financial capability assessed by UIDAI (F1, F2, F3 and F4) will be used such that F1 will be considered equivalent to NW1, F2 will be considered equivalent to NW2, F3 will be considered equivalent to NW3 and F4 will be considered equivalent to NW4.

The bidders will be eligible to bid for one or more zones and can also be allocated work for one or more zones depending upon the criteria of **maximum bid capacity** (number of biometric enrolments) and **maximum work capacity** (number of biometric enrolments) as mentioned below:

Tier	Maximum Bid Capacity (Lakh)	Maximum Work Capacity (Lakh)
NW1	75	15
NW2	175	35
NW3	625	125
NW4	2500	500

The Maximum Bid Capacity is defined as the maximum number of biometric records (one record per person) that a bidder is eligible to bid for. Maximum Work Capacity is defined as the maximum number of biometric records (one record per person) that can be allocated to a bidder for biometric enrolment work. The Maximum Bid Capacity and Maximum Work Capacity may spread over one or more zones depending upon the resident rural population of various zones.

While bidding, each bidder must ensure that they bid for only those zones where total rural population is less than their maximum work capacity and the cumulative rural population of all zones that the bidder is bidding for does not exceed the maximum

bid capacity of that bidder. In case a bidder is found to be bidding for zones whose cumulative rural population is higher than the bidder's bid capacity, then the entire bid of that bidder (including all quotes provided for various zones) will be rejected.

For all zones, only those bids that fulfill all the terms and conditions as mentioned in this RFQ will be taken up for further consideration. For each zone, the lowest price quoted (the price per person for biometric enrolment) shall be termed as L1 and the rest of the quotes shall be ranked, in ascending order of prices quoted, as L2, L3, L4 and so on.

The financial bids for all zones will be opened simultaneously. However, the sequencing of zones for the purpose of allocation of work will be done as per the following criteria:

- i)** For each zone, a frequency score will be arrived at based on the number of bidders for that zone and the number of zones that each of those bidders has bid for. For example, if there are three bidders for a zone and each bidder has bid for 5, 2 and 7 zones respectively then the frequency score for that zone will be $5+2+7 = 14$.
- ii)** All zones will then be ranked from the lowest frequency score to the highest and the allocation of zones will start from the zone with the lowest frequency score. In case, two or more zones happen to have the same frequency score, then the zone with the lower population will be allocated first.

The work will then be allocated to the L1 bidder of that zone. However, if there are multiple L1 bidders, the work will be divided in equal proportions amongst all L1 bidders.

Once a bidder reaches its maximum work capacity, then the bidder will not be considered eligible for the subsequent zones. In such a scenario, where such bidders happen to be holding the lowest bid (L1) for any of the remaining zones, then the next eligible bidder (holding L2, L3 or higher bid) will be invited to match the L1 price in order to win that zone. In case the first eligible bidder fails to match the L1 price then the bidder with the next higher bid will be invited to match the L1 bid. In case all eligible bidders of a particular zone fail to match the L1 price, then the actual bidder holding the L1 bid will have to accept the work for that zone irrespective of the L1 bidder's maximum work capacity as described under Section 4.

In all the above cases, the decision of the Purchaser regarding allocation of work for biometric enrolment in a zone to the successful bidder(s) will be final & binding on all the bidders and no further discussion will be held with the bidders on this matter under any circumstances.

5. PAYMENT TERMS

- 60% of the total payments due to MSP per zone (based on the number of biometric enrolments done in the allocated zone) will be made upon completion of biometric enrolment work, and acceptance of biometric enrolment work, as reported and verified by the purchaser or any other agency nominated by the Purchaser on its behalf.
- The schedule for the initial 60% payments due to the MSP per zone is as follows:

S. No.	Biometric Enrolments per zone (% age of the total volume of data as per SLA 6.1)	Number of Days	Payment (%age of total payments to be made)
1.	25%	1 to 90	15%
2.	25% (Cumulative 50%)	91 to 180	15%
3.	25% (Cumulative 75%)	181 to 270	15%
4.	25% (Cumulative 100%)	271 to 360	15%
Total	100%	360	60%

- 20% of the total payment due to the MSP shall be made upon completion of LRUR printing and handing over biometric data to the Purchaser, as verified by the Purchaser and necessary certifications received as provided in the RFQ. This may be as verified by the Purchaser or any agency nominated by the Purchaser on its behalf.
- The number of duplicate Biometric records, as found during the quality check process of RGI/UIDAI, will be deducted from the total number of records captured by the MSP and the adjustments thereof will be made out of the balance 20% payment due to MSP.
- The balance 20 % of the final payment due to MSP per zone will be made only upon submission of complete data by the Purchaser to RGI and receiving an acceptance on the completeness and quality of data from RGI..
- The selected bidder(s) will raise invoice for biometric enrolment within the defined time period and submit such invoices to the Purchaser to the attention of following person:
Attention:
The Director,
DOEACC Society, Chandigarh Centre,
SCO 114-116, Sector 17B, Chandigarh – 160 017
- The Purchaser will make all efforts to release the payment within 30 days of submission of invoice to the extent possible subject to the verification of actual work completed by the selected bidder(s).
- If actual quantum of work turns out to be lesser than estimated one, the rates quoted shall remain unchanged.

6. PERFORMANCE MANAGEMENT

6.1. Service Level Agreement (SLA)

The selected bidder(s) will be responsible for achievement of SLAs mentioned below during the entire period of the contract.

S. No.	Performance Indicator	Service Level Metric	Penalty on breach of service level
1	Biometric Data Completeness	All Biometric Data (Face Photo, Iris of both eyes and 10 fingers of hands) to be completely captured for each resident as per UIDAI Norms.	25% of the cost ordered per Biometric Enrollment and LRUR printing PLUS (+) 5% of the cost ordered per Biometric Enrollment each day from the day of completeness check till the entry is completed.
2	Biometric Data Capture targeted as per camp schedule/ population turnout.	The total volume of Biometric data records captured.	For each day of delay beyond target period (3 days), X% of the cost ordered per biometric enrollment, multiplied by the no. of records not captured/wrongly captured at the end of target period (3 days), where X is as follows: <ul style="list-style-type: none"> • 2% for 1 days • 4% for 2 days • 10% for 3 days or more
3	Quality of Biometric data	100% accurate capture of biometric data as per UIDAI Norms	25% of the cost ordered per biometric enrollment
4	Trained and Certified Staff	100% trained and certified enrollers as per the specifications of UIDAI/RGI.	100% of the cost ordered per Biometric Enrollment for 60 records, for each instance of records captured by untrained and uncertified staff.
5	Quality of LRUR Printing	100% accurate readable printing of LRUR as per specifications provided by DOEACC/RGI.	5% of the cost ordered per biometric enrollment.
6	Safe and secure custody of data	100% encrypted data with physical security to ensure zero	100% of the cost ordered per biometric enrollment multiplied by the total number of

		unauthorized access	enrollment found in unencrypted manner or without physical security
7	Data transfer from the biometric camp to the Purchaser	Zero delay in transferring captured data to the Purchaser/any other designated agency from the target date	Rs. 1000/- per day of delay in transferring data to the Purchaser/ any other designated agency
8	Assistance in the LRUR corrections	Zero delay in providing support from the target date	Rs. 1000/- per day of delay in assistance to data digitization MSP/any other designated agency

6.2. Debarment

If at any point of time, it is found that the selected bidder(s) is not enrolling biometric as per specifications given by the Purchaser, then the particular bidders(s) will be debarred from carrying out any further enrolment work with and other activities with immediate effect. In such cases, the Purchaser reserves the right to terminate the contract with the concerned Bidder(s) and impose penalties and take further action as deemed fit as per rules.

6.3. Work Re-Allocation

During the course of project execution, if a selected bidder consistently fails to meet the performance expectations of the purchaser, as determined by the Purchaser. The Purchaser reserves the right to terminate contract with the concerned bidder(s), impose penalties and take further step as deemed fit as per rules set by the purchaser from time to time. The remaining work of such bidder will be got done by the Purchaser at risk and cost of the bidder. The outgoing bidder shall be liable to pay for reallocated work to new bidder at the rates finalized by purchaser. The bidder(s) agree and acknowledge that such rates may be higher than the rates quoted by L1. The Purchaser shall be entitled to recover/ adjust/ deduct such amounts payable (to new bidder) from outgoing bidder under this or any other transactions/ order/ contract etc. Nothing herein shall be construed as precluding the Purchaser from invoking the provisions of clause 13 [k] of Annexure 4 to this RFQ.

7. BID OPENING AND EVALUATION

7.1. Evaluation Committee(s)

The Evaluation Committee(s) constituted by the Purchaser shall evaluate the financial Bids as per standard procedures.

The Evaluation Committee (s) shall at its own discretion have the authority to disqualify any or all bid(s) that it finds to be inappropriate without giving any reason/justification to the bidder.

The decision of the Evaluation Committee(s) on any of the above matters will be final and binding on all the bidders and no further discussion/interface will be held with the bidders whose bids are disqualified/ rejected.

7.2. Bid Opening and Evaluation

The financial evaluation of the bids will be taken in to account on the basis of the information supplied by the bidders in their financial bid (as per format in **Annexure 2, Format of Financial Bid**) as well as all other relevant documents submitted by the bidder.

The Evaluation Committee(s) shall evaluate all documents (Certificate of Incorporation from Registrar of Companies, Letter of Association in case of Consortium, Auditor Certified financial statements, Proof for Organization PAN, VAT/ Service Tax number etc.) submitted by the bidder and may disqualify any bidder whose documents are not found to be in order.

Post this evaluation, the bids of all 71 zones will be opened up simultaneously. Based on the price quoted by a bidder against each of the zones (that the bidder is eligible to bid for), the work will be allocated as per the work allocation mechanism defined under Section 4 of this RFQ. All bids shall be subject to arithmetical checking and corrections, if any, which will be carried out by the Purchaser. Ranking of bids as L1, L2 ... will be decided thereafter.

7.3. Signing of Contract

The selected bidder(s) shall be required to enter into a contract with the Purchaser, within fifteen (15) days of the award of the contract or within such extended period, as may be specified by the Purchaser.

This contract shall be on the basis of this document and such other terms and conditions as may be determined by the Purchaser, to be necessary for the due performance of the work, as envisaged herein and in accordance with the Bid and the acceptance thereof.

8. INSTRUCTION TO BIDDERS

8.1. Submission of Bid

1. The Bid Document (referred to as “the Bid” in this RFQ) should consists of the following documents:

1.	Letter of Intent (LoI) to submit bid in response to RFQ Invitation	As per Annexure 1, Format of Letter of Intent to submit bid in response to RFQ Invitation
2.	RFQ Document Fee Demand Draft	Section 1.1, point 11
3.	Earnest Money Deposit (EMD)	Section 1.1, point 12
4.	Financial Bid	As per Annexure 2, Format of Financial Bid
5.	Power of Attorney for Authorized Signatory	Bidder/Lead Bidder of Consortium to provide as per Legal format for PoA
6.	This RFQ document	
7.	Annexures to this document	
8.	Any other corrigendum that the Purchaser might release on a later date	
9.	A Plan of Implementation for this project in the zone(s) that the bidder is bidding for	As per Annexure 8, Format of Plan of Implementation

Each page of the Bid document must be numbered, signed and stamped by the authorized signatory of the bidder, who has the Power of Attorney (PoA) to commit the responding firm to contractual obligations.

In case of a discrepancy between the items on the above checklist and the actual documents/material submitted, the Purchaser reserves the right to declare the bid invalid and disqualify the bidder.

Also, in case the documents/material submitted are not as per the formats specified in this RFQ document, the Purchaser reserves the right to declare the bid invalid and disqualify the bidder..

Bid may be rejected at any stage of the evaluation, if it is found that the bidder has provided misleading information or has been black listed by a central or state government or agency thereof or has indulged in any malpractice/unethical practice and has not honored contractual obligation elsewhere.

2. The bids submitted in response to this RFQ, and all associated correspondence shall be written in English. Any interlineations, erasures or over writings shall

be valid only if they are countersigned by the authorized person signing the bid.

3. The currency(ies) of the Bid offer and the payments shall be in Indian Rupees (INR).
4. Bids received by facsimile shall be treated as defective, invalid and rejected. Only detailed complete bids received prior to the closing time and date for receipt of bids shall be treated as valid.
5. **One hard copy of the financial bid in a separate sealed envelope**, prepared in accordance with the procedures enumerated in the RFQ document should be submitted in a **sealed envelope** to the the Purchaser no later than the date and time laid down, at the address given in the **Section 1.2**.
6. The envelope should be super scribed with - **“FINANCIAL BID - RFQ FOR PROVIDING MANAGED BIOMETRIC ENROLMENT SERVICES FOR THE CREATION OF NATIONAL POPULATION REGISTER (NPR) FOR USUAL RESIDENTS OF RURAL AREAS IN INDIA”** and **“<name & code> of zones”** for which bidder is bidding for.
7. All other eligibility documents mentioned at Section 1.4 along with other necessary and supportive document & EMD should be placed in a separate sealed envelope super scribed with - **“Eligibility documents - RFQ FOR PROVIDING MANAGED BIOMETRIC ENROLMENT SERVICES FOR THE CREATION OF NATIONAL POPULATION REGISTER (NPR) FOR USUAL RESIDENTS OF RURAL AREAS IN INDIA”** and **“<name & code> of zones”** for which bidder is bidding for.
8. The sealed envelope containing the **FINANCIAL BID & Eligibility documents** should be placed in a larger single envelope, properly sealed, and super scribed with **“RFQ FOR PROVIDING MANAGED BIOMETRIC ENROLMENT SERVICES FOR THE CREATION OF NATIONAL POPULATION REGISTER (NPR) FOR USUAL RESIDENTS OF RURAL AREAS IN INDIA - DO NOT OPEN BEFORE 11:00 A.M. ON 01-November-2011”** and **“<name & code> of Zones”** for which bidder is bidding for. All envelopes should be addressed to the Addressee specified at **Section 1.2** and bear the name and address of the Bidder/Lead Bidder of the consortium submitting the bid. CD media that contains softcopy of the bid must be duly signed using a “Permanent Pen/Marker” and should bear the name of the Bidder/Lead Bidder of the consortium, submitting the Bid.
9. The Bids submitted should be concise and contain only relevant information as required under this RFQ document.
10. The bidders submitting their bids would be responsible for all of its expenses, costs and risks incurred towards preparation and submission of their bids, attending any pre-bid meetings and visiting the sites or any other location in

connection therewith etc. The Purchaser shall, in no case, be responsible or liable for any such costs whatsoever, regardless of the outcome of the process.

11. Project Implementation Plan to be submitted as per the format provided at Annexure 8 detailing how the bidder plans to implement the project in the zones that it is bidding for.

8.2. Validity of Bid submitted

The bids submitted by the firms/agencies shall remain valid for a period of 90 days after the closing date (deadline) for submission of bids prescribed in this document. A bid valid for shorter period may be rejected as non-responsive. The Purchaser may solicit the bidders' consent to an extension of RFQ validity (but without the modification in their Bid).

8.3. Clarifications on Bid submitted

During evaluation, the Purchaser may, at its discretion, ask the respondents for clarifications on their bids. The Bidders are required to respond within the time frame prescribed by the Purchaser.

8.4. Amendments of RFQ Document

At any time prior to the deadline for submission of the Bid, the Purchaser may for any reason, amend the RFQ document by issuing suitable Corrigendum. Any corrigendum issued in this regard will be communicated through email/written letter to the pre-qualified bidders, as well as be published on the website of the Purchaser, and such amendments shall be binding on bidders.

8.5. Disqualification

The Purchaser may at its sole discretion and at any time during the evaluation of bid, disqualify any bidder, if the bidder:

- a. submits the bid after the response deadline;
- b. makes misleading or false representations in the forms, statements and attachments submitted in proof of the eligibility requirements;
- c. exhibits a record of poor performance such as abandoning works, not properly completing the contractual obligations, inordinately delaying completion or financial failures, etc. in any project in the preceding three years;
- d. submits a bid that is not accompanied by required documentation or is non-responsive to the terms and conditions and stipulated herein;
- e. fails to provide clarifications related thereto within given time frame, when sought;
- f. submits more than one bid;

- g. has been declared ineligible by the Government of India/State/UT Government for corrupt and fraudulent practices.
- h. In case the bidder exceeds the maximum bid capacity.

8.6. Performance Bank Guarantee

Within 7 days of the selected bidder(s) being intimated about their selection, they shall submit an unconditional, unequivocal and irrevocable Performance Bank Guarantee (PBG) of 10 % (Ten Percent) of the contract value, from any Nationalized Bank and valid for the entire period of the contract plus an additional 12 months beyond the contract period and any applicable extension periods as may be required by the Purchaser. The format for PBG is provided in **Annexure 3, Format of Performance Bank Guarantee (PBG)**.

8.7. Period of Contract

The contract would be for an initial period of Two (2) years, which may be extended at purchaser's discretion depending upon the nature of work.

8.8. Confidentiality

Information relating to the examination, clarification, comparison and evaluation of the bids submitted shall not be disclosed to any of the responding firms or their representatives or to any other persons not officially concerned with such process until the selection process is over. The undue use by any responding firm of confidential information related to the process may result in rejection of its bid.

8.9. Disclaimer

Bids received late will not be considered and will be returned unopened to the respondents. The Purchaser reserves the right to

- a) Reject any / all bids without assigning any reasons thereof,
- b) Relax or waive any of the conditions stipulated in this RFQ document as deemed necessary in the best interest of the objective of the scheme/project without assigning any reasons thereof, and
- c) Include any other item in the scope of work at any time after consultation in the pre-bid meeting or otherwise.

8.10. Corrupt or Fraudulent Practices

In the event of the bidder engaging in any corrupt or fraudulent practices during the bidding process, the Purchaser reserves the right to reject such bids at its sole discretion.

For the purpose of this clause:

“Corrupt Practice” means the offering, giving, receiving or soliciting of anything of value to influence the action of an official of the Purchaser or DIT in the selection

process. It also includes bringing undue influence through any quarter or interfering directly or indirectly in the selection process to affect its outcome.

“Fraudulent Practice” means a misrepresentation of facts in order to influence the evaluation and selection process to the detriment of the Purchaser.

8.11. Limits on Promotion/Publicity/Advt.

The selected bidders shall not perform any kind of promotion, publicity or advertising etc. at the Purchaser or DIT and their field offices through any kinds of hoardings, banners or the like without the express prior written consent of the Purchaser.

ANNEXURE 1

Format of Letter of Intent to submit bid in response to RFQ Invitation

(To be submitted on the Letterhead of the responding firm)

{Place}

{Date}

To

**The Director,
DOEACC Society, Chandigarh Centre,
SCO 114-116, Sector 17B, Chandigarh - 160 017**

Ref: RFQ No. 0006/2011 dated 15/09/2011

Subject: Submission of bid in response to the **RFQ for Providing Managed Biometric Enrolment Services for the Creation of National Population Register (NPR) for Usual Residents of Rural Areas in India.**

Dear Sir,

1. Having examined the RFQ document, we, the undersigned, herewith submit our bid in response to your RFQ No. 0006/2011 dated 15/09/2011 **for Providing Managed Biometric Enrolment Services for the Creation of National Population Register (NPR) for Usual Residents of Rural Areas in India**, in full conformity with the said RFQ document.
2. We have read and understood the provisions of the RFQ document and confirm that these are acceptable to us. We conform that only the terms and conditions in the RFQ shall apply; we further declare that additional conditions, variations, deviations, if any, found in our bid shall be without any effect whatsoever.
3. We hereby declare that we satisfy all the eligibility criteria as specified in this RFQ and agree to abide by all the terms and conditions specified therein.
4. We agree to abide by this bid, consisting of this letter, the detailed response to the RFQ and all attachments, and validity of the bid shall be for a period of **90 days** from the closing date fixed for submission of bids as stipulated in the RFQ document.
5. The Earnest Money Deposit (EMD) of **Rs xxx Lakh** submitted by us may be forfeited and en-cashed under any of the circumstances as specified in Para 12(ii) under sub-section 1.1 of Section 1 of this RFQ.
6. We hereby declare that we are not involved in any litigation that may have an impact of affecting or compromising the delivery of services as required under this assignment and we are not under a declaration of ineligibility for corrupt or fraudulent practices.
7. We confirm that we have not been blacklisted by any department/society/body/organization of central/state government.

8. We hereby declare that all the information and statements made in this bid are true and accept that any misrepresentation /wrong information contained in it or /suppression of material or relevant facts/figures may lead to our disqualification.
9. We understand that you are not bound to shortlist / accept any bid you receive.

Our correspondence details with regards to this bid are:

S. No.	Information	Details
1.	Name of responding firm:	
2.	Address of responding firm:	
3.	Name, Designation and Address of the contact person to whom all references shall be made regarding this RFQ:	
4.	Telephone no. of contact person:	
5.	Mobile no. of contact person:	
6.	Fax no. of contact person:	
7.	E-mail address of contact person:	
8.	Website URL of the responding firm	

We hereby declare that our bid submitted in response to this RFQ is made in good faith and the information contained is true and correct to the best of our knowledge and belief.

Sincerely,

Date:

[FIRM'S NAME]

Place:

Signature

Name

Title

Seal of the Firm

ANNEXURE 2**Format of Financial Bid***(To be submitted on the Letterhead of the responding firm)**[Location, Date]*

To

The Director,**DOEACC Society, Chandigarh Centre,****SCO 114-116, Sector 17B, Chandigarh - 160 017**

Ref: RFQ No. 0006/2011 dated 15/09/2011

Subject: Submission of bid in response to the RFQ for **“Providing Managed Biometric Enrolment Services for the Creation of National Population Register (NPR) for Usual Residents of Rural Areas in India”**.

Dear Sirs,

We, the undersigned, offer to provide the Managed Biometric Enrolment Services for creation of National Population Register (NPR) for usual Residents of Rural areas in India in accordance with your Request for Quotation dated **[Insert Date]**.

The cost per person for Biometric Enrolment and LRUR Printing is as follows:

Zone Code (As per Annexure 6)	Cost per biometric enrolment including LRUR Printing (in Rs.)	Total Cost (in Rs.)
[insert Code]	[Quote amount in words and figure]	[Quote total amount by multiplying the cost per person and the total rural population of the zone]
[Insert Code]	[Quote amount in words and figure]	[Quote total amount by multiplying the cost per person and the total rural population of the zone]
-----	-----	-----
[Insert Code]	[Quote amount in words and figure]	[Quote total amount by multiplying the cost per person and the total rural population of the zone]

The above mentioned cost(s) per person for Biometric Enrolment is inclusive of all Government taxes taxes/duties/levies/cess etc.

We remain,

Yours sincerely,

Authorized Signature [In full and initials] : _____

Name and Title of Signatory : _____

Address of Firm : _____

Seal of the Firm

ANNEXURE 3

Format of Performance Bank Guarantee (PBG)

BANK GUARANTEE NO.

DATE

PERIOD OF BANK GUARANTEE:- VALID UPTO (36 months from the date of Selection)

AMOUNT OF GUARANTEE: Rs. -----

To

**The Director,
DOEACC Society, Chandigarh Centre,
SCO 114-116, Sector 17B, Chandigarh - 160 017**

THIS DEED OF GUARANTEE EXECUTED ON THIS ___ Day of _____ 2011 by {Name of the Bank issuing guarantee} a Nationalized Bank, constituted under the Banking Companies (Acquisition and Transfer of Undertakings) Act 1970, having its Head office at (H.O. Address) and one of the Branch offices at (Branch address) hereinafter referred to as the 'Guarantor Bank' (which expression unless it be repugnant to the context or meaning thereof shall include its successors and assigns.) in favour of The Director, DOEACC Society, Chandigarh Centre, SCO 114-116, Sector 17B, Chandigarh (hereinafter referred to as "Purchaser" which expression shall unless it be repugnant to the context or meaning thereof shall include its successors and assigns).

Whereas Selection Notification No. ----- dated ----- (Hereinafter called the "Selection Notification") for selecting M/s. ----- for Providing Managed Biometric Enrolment Services for the Creation of National Population Register (NPR) for Usual Residents of Rural Areas in India issued by the Purchaser on M/s. ----- (Hereinafter referred to as 'the Managed Service Provider ') stands accepted by the Managed Service Provider.

And whereas to ensure due performance of the obligations of the Managed Service Provider to the satisfaction of the Purchaser towards Providing Managed Biometric Enrolment Services for the Creation of National Population Register (NPR) for Usual Residents of Rural Areas in India the said performance and in terms thereof by the Managed Service Provider as aforesaid, the Guarantor Bank at the request of the Managed Service Provider has agreed to give guarantee as hereinafter provided.

NOW THIS GUARANTEE WITNESSETH AS FOLLOWS:

In consideration of the Purchaser, having engaged the Managed Service Provider for a period of two years for Providing Managed Biometric Enrolment Services for the

Creation of National Population Register (NPR) for Usual Residents of Rural Areas in India (Name of the Guarantor Bank) do hereby undertake as under:

- a) To indemnify and keep indemnified the Purchaser to the extent of the sum of Rs. ---
----- -- /- (Rs. ----- only) for the losses and damages that may be
caused to or suffered by the Purchaser in the event of non-performance or part/under
performance of whatever nature on the part of the Managed Service Provider in
discharging their obligations under the said contract against the above selection
notification order and further undertake to pay immediately on demand to the
Purchaser the amount claimed under this guarantee not exceeding Rs. ----- /-
(Rs. -----only) without demur and without the Purchaser
needing to prove or to assign reasons for the demand so made for the sum specified
therein and mere written claim or demand of the Purchaser shall be conclusive and
binding on the guarantor Bank as to the amount specified under these presents.
- b) The guarantee herein contained shall remain in full force and effect during the
period that would be taken for the performance of the obligations under the contract
against the Selection Notification and that it shall continue to be enforceable till all the
dues of the Purchaser under or by virtue of the said contract against the Selection
Notification have been fully paid and its claims satisfied or discharged or till
_____Office/Department/Ministry of _____
certifies that the terms and conditions of the said contract against the Selection
Notification have been fully and properly carried out by the Managed Service Provider
and accordingly discharges this guarantee. Unless a demand or claim under this
guarantee is made on us in writing on or before the _____ we shall be
discharged from all liability under this guarantee thereafter.
- c) This guarantee shall not in any way be affected by the change in the constitution of
the Managed Service Provider or of guarantor bank nor shall be affected by the
change in the constitution, amalgamation, absorption or reconstruction of the
Purchaser or otherwise but shall ensure for and be available to and enforceable by the
absorbing amalgamated or reconstructed Company of the Purchaser.
- d) We, _____ (indicate the name of bank) further
agree with the Purchaser that the Purchaser shall have the fullest liberty without our
consent and without affecting in any manner our obligations hereunder to vary any of
the terms and conditions of the said contract against the Selection Notification or to
extend time of performance by the Managed Service Provider from time to time or to
postpone for any time or from time to time any of the powers exercisable by the
Purchaser against the Managed Service Provider and to forbear or enforce any of the
terms and conditions relating to the said contract against the Selection Notification
and we shall not be relieved from our liability by reason of any such variation, or
extension being granted to the Managed Service Provider or for any forbearance, act
or omission on the part of the Purchaser or any indulgence by the Purchaser to the
Managed Service Provider or by any such matter or thing whatsoever which under the
law relating to sureties would, but for this provision, have effect of so relieving us.

e) We, _____ (indicate the name of bank) undertake not to revoke this guarantee during its currency except with the previous consent of the Purchaser in writing.

f) Notwithstanding anything contained above

The liability of the guarantor Bank under this deed of guarantee is restricted to Rs. ----
----- /- (Rs. ----- only). This guarantee shall remain in full
force till (mention date) and the guarantor Bank is liable to pay the guaranteed
amount or any part thereof under this Bank Guarantee only and only if the Purchaser
serves upon the guarantor Bank a written claim or demand on or before (mention
date) at (name of the guarantor Bank and branch).

IN WITNESS WHEREOF the authorized signatories of the said (Guarantor Bank) have
signed this deed for and on behalf of the guarantor on the date first hereinabove
mentioned.

Place

For

Date

Authorized Signatories
Seal

ANNEXURE 4

Conditions of Managed Biometric Enrolment Services Contract

The operating clauses would emerge from the technical and financial processes finalized with the MANAGED SERVICE PROVIDER (MSP) selected for the project. In addition, the Managed Biometric Enrolment Services contract will inter-alia includes the following terms:

1. Definitions

In the Contract, the following terms shall be interpreted as indicated:

“DIT” means the Department of Information Technology, Government of India, or any other authorized representative of the DIT.

“DOEACC” (hereinafter called “the Purchaser”) means, an autonomous Scientific Society of Department of Information technology, Ministry of Communication & Information technology, Govt. of India.

The “Work Order” means the selection notification issued to the MSP by the Purchaser pursuant to the selection of the MSP for provision of Managed Biometric Enrolment Services for the Creation of National Population Register (NPR) for Usual Rural Residents of India.

The “Contract” means the Managed Biometric Enrolment Services agreement entered into between the Purchaser and the selected bidder (hereinafter called the MSP) as recorded in the Contract Form signed by the Purchaser and the MSP, including all attachments and annexure thereto and all documents incorporated by reference therein.

2. Deliverables

The final list of Deliverables would be finalized during contract negotiation with the selected MANAGED SERVICE PROVIDER (MSP).

3. Time Schedule

The Contract shall be valid initially for a time period of Two (2) Years from the date of award of contract and may be extended depending upon the nature of work.

4. Payment Terms and Schedule

The payment terms are explained in **Section 5 - Payment Terms**. A pre-receipted bill in triplicate (for the audit and independent monitoring) shall be submitted as per the schedule mentioned in the RFQ.

Note – All the payments will be made within 30 days of acceptance of deliverables for the corresponding period to the extent possible and subject to the verification done by the Purchaser on the actual work completed during the invoice period.

5. Commercial Terms

The Purchaser will release the payment within 30 days of submission of invoice, to the extent possible, subject to invoice and all supporting documents being in order and verification done by the Purchaser or any agency nominated by it on its behalf on the actual work completed during the invoice period.

6. Disclaimer

The selected MSP is not authorized to provide UID Number, Citizenship or any residency benefits to the enrollees. The selected bidder shall be only responsible for biometric enrolments and submitting it to the Purchaser, the Purchase in turn will submit this data to ORG&CCI.

7. Liabilities

- (a) The MSP shall indemnify the Purchaser against all third party claims arising out of a court order or arbitration award for infringement of any of the intellectual property rights (e.g. patent, trademark/copy right /breach of confidentiality etc..) arising from the use of the supplied services or any part thereof or arising out of or incidental to the contract/work order placed on MSP or for breach of security in relation to the data entrusted to or used by or provided by the MSP or for breach of clause 10 below.
- (b) Either party will accept liability without limit (1) for death or personal injury caused to the other party by its negligence or the negligence of its employees acting in the course of their employment; (2) any other liability which by law either party cannot exclude. This does not in any way confer greater rights than what either party would otherwise have at law.
- (c) The Work Order does not contemplate any consequential, indirect, lost profit, claim for tort or similar damages of any form to be paid by the MSP to the Purchaser or any other organizations.
- (d) Except for the indemnification provisions ;Notwithstanding anything to the contrary contained in the Work Order, in no event will the MSP be liable to the Purchaser, (a) for any amount in excess of 100% of the total professional fees payable for the respective Project. This limit of liability is not applicable to clause 'a' above.

- (e) No action regardless of form, arising out of this Contract, may be brought by either party more than one year after the cause of action has accrued.

8. Progress of the Project

Progress of the project should be updated on a daily basis on the Management Information System (hereinafter called "the MIS") that will be made accessible to the MSP by the Purchaser. MSP shall be fully responsible for timely and accurate updation of MIS. Additionally, the progress of the project should be intimated in writing to the Purchaser on a weekly basis.

9. Confidentiality

- a) Neither party will disclose to any third party without the prior written consent of the other party any confidential information which is received from the other party for the purposes of providing or receiving Services which if disclosed in tangible form is market confidential or if disclosed otherwise is confirmed in writing as being confidential or if disclosed in tangible form or otherwise, is manifestly confidential. Each party will take measures to protect the confidential information of the other party that, in the aggregate are no less protective than those measures it uses to protect the confidentiality of its own comparable confidential information, and in any event, not less than a reasonable degree of protection. Both parties agree that any confidential information received from the other party shall only be used for the purposes of providing or receiving Services under this Contract

These restrictions will not apply to any information which:

- I. Is or becomes generally available to the public other than as a result of a breach of an obligation under this Clause; or
 - II. is acquired from a third party which owes no obligation of confidential in respect of the information ; or
 - III. is or has been independently developed by the recipient or was known to it prior to receipt
- b) Notwithstanding Clause (a) mentioned above, either party will be entitled to disclose confidential information of the other (1) to its respective insurers or legal advisors, or (2) to a third party to the extent that this is required by any or where there is a legal right. Duty or requirement to disclose, provided that in the case of sub- Clause(ii) (and without branching any legal or regulatory requirement) where reasonably practicable not less than 2 business days notice in writing is first given to the other party.
- c) Without prejudice to the foregoing provision of this Clause above, bidder may cite the performance of the services to clients and projective clients as an indication of its experience

- d) The MSP shall not, without prior written consent of the Purchaser, disclose the commercial terms of this work order and contract to any person or organization other than a person employed by the MSP in the course of performance of the Contract. Further, the extent of such disclosure shall be only to that required for performance of the services under this contract.
- e) This clause on Confidentiality shall be valid for a further period of two years from the date of expiry or termination of the contract or completion of the project in the assigned zone, or until the UIDs are informed to respective persons/citizens by RGI/Census office, whichever is later

10. Confidentiality of Data

The MSP and its Personnel shall maintain absolute confidentiality and security of data at all times before, during, and after the performance of its services. The MSP and its Personnel shall not make or maintain unauthorized copies, either electronic or physical or in any other form, of the data or confidential information received or acquired during the course of performance of its services. The MSP and its Personnel shall not disclose, except with the prior written consent of the Purchaser, any data or confidential information received or acquired during the course of performance of its services to any person or entity, nor shall the MSP and its Personnel make public the recommendations formulated in the course of, or as a result of, the performance of its services.

11. Other Terms & Conditions

- a) The end product of the work assignment carried out by the MSP, in any form, or/and/including any and all intellectual property created/developed by MSP or consortium members shall be the sole property of The Purchaser. The MSP or consortium member hereby undertakes to execute any document/undertaking/ affidavit in favour of the purchaser to that effect
- b) The MSP shall not outsource the work to any other associate / franchisee / third party under any circumstances without the prior approval of the Purchaser.
- c) The MSP shall perform the services and carry out its obligations under the contract with due diligence and efficiency, in accordance with generally accepted techniques and practices used in the industry and with professional engineering and training / consulting standard recognized by national / international professional bodies and shall observe sound management practice. It shall employ appropriate advanced technology, and safe and effective methods. The MSP shall always act, in respect of any matter relating to this Contract, as faithful advisors to the Purchaser and shall at all times, support and safeguard legitimate interests of the Purchaser.

- d) The MSP automatically agrees with the Purchaser for honoring all aspects of fair trade practices in executing the work orders placed by the Purchaser.
- e) In the event the MSP or the concerned Division of the company is taken over / bought over by another company, all the obligations under the agreement with the Purchaser, should be passed on the compliance by the new company / new Division in the negotiation for their transfer.
- f) Statutory Employment Records, submitted by the MSP as an evidence of employment of its personnel engaged in providing the managed services under the Contract, may be subject to Third Party examination.
- g) Should any provision of this RFQ/contract be found to be inoperative, void or invalid by a court of competent jurisdiction, all other provisions of this RFQ shall remain in full force and effect for the duration of this RFQ, it being the intention of the parties that no portion of this RFQ or provision herein shall become inoperative or fail by reason of the invalidity of any other portion or provision.
- h) Award of contract to selected bidder shall not create any relationship between the Parties such as agency, partnership, employer-employee etc,
- i) E-mail correspondence should not be taken as substitute for any official signed hardcopy correspondence in all important matters such as responsibilities of parties, financial matters , termination, extension, modification etc

12. Force Majeure

- a) Force majeure clause shall mean and be limited to the following in the execution of the contract placed by the Purchaser:
 - War / hostilities
 - Riot or Civil commotion
 - Earth quake, flood, tempest, lightening or other natural physical disaster
 - Restriction imposed by the Government or other statutory bodies, which is beyond the control of the MSP, which prevent or delay the execution of the order by the MSP.
- b) Labour/manpower/financial/commercial/infrastructural/industrial/power/material/ equipment shortage/ problems/ shortages/ difficulties/ breakdowns /accidents etc. shall not be considered/ treated as force majeure events. The MSP shall advice the Purchaser in writing, duly certified by the local Chamber of Commerce, the beginning and the end of the above causes of delay, within seven days of the occurrence and cessation of the force majeure

conditions. In the event of a delay lasting for more than one month, if arising out of clauses of force majeure, the Purchaser reserves the right to cancel the contract without any obligation to compensate the MSP in any manner for what so ever reason, subject to the provision of clause mentioned.

13. Termination

The Purchaser may, without prejudice to any other remedy for breach of Contract, terminate this Contract in case of the occurrence of any of the events specified in paragraphs (a) to (i) of this Clause. In such an occurrence, the Purchaser shall give a not less than thirty (30) days' written notice of termination to the Supplier, and sixty (60) days' in the case of the event referred to in (e).

- a) If the MSP does not remedy a failure in the performance of their obligations under the Contract, within thirty (30) days after being notified or within any further period as the Purchaser may have subsequently approved in writing
- b) If the MSP becomes (or, if the MSP consists of more than one entity, if any of its Members becomes and which has substantial bearing on providing Services under this contract) insolvent or go into liquidation or receivership whether compulsory or voluntary.
- c) If the MSP, in the judgment of the Purchaser has engaged in corrupt or fraudulent practices in competing for or in executing the Contract.
- d) If, as the result of Force Majeure, the MSP is unable to perform a material portion of the Services for a period of not less than sixty (60) days.
- e) If the Purchaser, in its sole discretion and for any reason whatsoever, decides to terminate this Contract.
- f) If the MSP submits to the Purchaser a false/misleading statement which has a material effect on the rights, obligations or interests of the Purchaser.
- g) If the MSP places itself in position of conflict of interest or fails to disclose promptly any conflict of interest to the Purchaser.
- h) If the MSP fails to provide the quality services as envisaged under this Contract.
- i) If the MSP fails to comply with any final decision reached as a result of arbitration proceedings pursuant to Clause 14 hereof.
- j) In the event of any breach or failure on the part of the MSP to adhere to the Confidentiality norms as stipulated in the contract, penal provisions including both civil and criminal, as applicable under various laws and statutes of the land shall apply.
- k) In the event the Purchaser terminates the Contract in whole or in part, the Purchaser may procure, upon such terms and in such manner as it deems appropriate, services similar to those undelivered or not performed, or not corrected/cured/repaired/rectified, and the MSP shall be liable to the Purchaser for any additional costs for such similar services. However, the

MSP shall continue performance of the Contract to the extent not terminated.

14. Arbitration

- a) In the event of any dispute or differences arising under these conditions or any special conditions of the contract in connection with this contract or in respect of any defined legal relationship associated therewith or derived there from, the parties agree to submit that dispute to arbitration under the Arbitration and conciliation Act 1996. . he language of the arbitration proceedings shall be English. The place of arbitration proceedings shall be New Delhi.
- b) Any other terms and conditions, mutually agreed prior to finalization of the order/agreement shall be binding on the MSP.
- c) The Purchaser and the bidder shall make every effort to resolve amicably by direct negotiation any disagreement or dispute arising between them under or in connection with the purchase/work order/contract/RFQ.
- d) In the case of dispute arising upon or in relation to or in connection with the Contract between the Purchaser and the MSP, which has not been settled amicably, any party can refer the dispute for Arbitration under (Indian) Arbitration and Conciliation Act, 1996. Such disputes shall be referred to the sole arbitrator nominated by DIT.
- e) Arbitration proceedings shall be held in New Delhi and the language of the arbitration proceedings and that of all documents and communications between the parties shall be English.
- f) The decision of the arbitrators shall be final and binding upon both parties. The expenses of the arbitrators as determined by the arbitrators shall be shared equally by the Purchaser and the MSP. However, the expenses incurred by each party in connection with the preparation, presentation shall be borne by the party itself. All arbitration awards shall be in writing and shall state the reasons for the award. The courts in New Delhi only shall have exclusive jurisdiction to try and entertain any dispute arising there from.

15. Applicable Law

The contract shall be governed by the laws and procedures established by Govt. of India, within the framework of applicable legislation and enactment made from time to time concerning such commercial dealings/processing.

ANNEXURE 5**Composition of Zones with Estimated Rural Population for Biometric Enrolment**

S. No.	State	Zone Code	District	District Population* (Rural)	Zonal Population (Rural)	Zonal Population (Rural) Aged At Least 5-Years (Estimated @ 90% of Zonal Population - Rural)
1	Arunachal Pradesh	Zone 1			10,44,104	9,39,694
			Anjaw	17,600		
			Changlang	1,35,641		
			Upper Dibang Valley	16,804		
			East Kameng	50,612		
			East Siang	78,518		
			Kurung Kumey	40,383		
			Lohit	1,22,518		
			Lower Dibang Valley	40,332		
			Lower Subansiri	62,649		
			Papumpare	71,953		
			Tawang	36,658		
			Tirap	1,02,038		
			Upper Siang	40,036		
			Upper Subansiri	47,508		
			West Kameng	81,487		
			West Siang	99,367		
2	Assam	Zone2			94,98,227	85,48,404
			Cachar	14,92,241		
			Hailakandi	5,98,544		
			Kamrup	19,36,928		
			Karbi Anglong	8,65,657		
			Karimganj	11,20,951		
			Morigaon	8,85,922		
			Nagaon	24,43,610		
			North Cachar Hills	1,54,373		
3	Assam	Zone 3			70,64,768	63,58,292
			Dhemaji	6,39,734		
			Dibrugarh	11,47,961		
			Golaghat	10,38,169		
			Jorhat	9,93,481		
			Lakhimpur	9,88,628		
			Sivasagar	11,45,468		
			Tinsukia	11,11,326		
4	Assam	Zone 4			1,14,78,060	1,03,30,254
			Baksa	10,19,222		
			Barpeta	15,38,257		

			Bongaigoan	6,28,706		
			Chirang	4,63,272		
			Darrang	9,01,093		
			Dhuburi	16,07,928		
			Goalpara	9,06,160		
			Kokrajhar	9,49,565		
			Nalbari	8,08,376		
			Sonitpur	17,92,085		
			Udalguri	8,63,395		
5	Bihar	Zone 5			1,36,19,222	1,22,57,300
			Bhojpur	23,16,876		
			Buxar	15,28,106		
			Kaimur (Bhabua)	14,96,759		
			Nalanda	24,20,279		
			Patna	33,08,472		
			Rohtas	25,48,730		
6	Bihar	Zone 6			1,02,04,692	85,47,588
			Arwal	7,07,371		
			Aurangabad	22,11,598		
			Gaya	35,96,975		
			Jehanabad	16,83,244		
			Nawada	20,05,504		
7	Bihar	Zone 7			90,44,366	81,39,930
			Chapra	35,40,077		
			Gopalganj	24,26,458		
			Siwan	30,77,832		
8	Bihar	Zone 8			1,84,52,192	1,66,06,973
			East Champaran	44,26,424		
			Muzaffarpur	40,78,033		
			Sheohar	5,93,639		
			Sitamarhi	30,35,288		
			Vaishali	30,38,119		
			West Champaran	32,80,688		
9	Bihar	Zone 9			1,17,00,618	1,05,30,556
			Darbhanga	36,34,129		
			Madhubani	41,40,883		
			Samastipur	39,25,606		
10	Bihar	Zone 10			53,83,277	48,44,949
			Madhepura	17,50,415		
			Saharsa	16,59,618		
			Supaul	19,73,244		
11	Bihar	Zone 11			92,27,402	83,04,662
			Araria	24,31,508		
			Katihar	26,09,233		
			Kishanganj	14,00,808		
			Purnia	27,85,853		
12	Bihar	Zone 12			42,27,718	38,04,946
			Banka	18,62,824		
			Bhagalpur	23,64,894		
13	Bihar	Zone 13			80,27,935	72,25,142

			Begusarai	26,90,092		
			Jamui	15,54,662		
			Khagaria	14,44,832		
			Lakhisarai	8,21,382		
			Munger	9,83,940		
			Sheikhpura	5,33,027		
14	Chhattisgarh	Zone 14			47,38,696	42,64,826
			Durg	20,85,752		
			Kabirdham/ Kawarda	6,47,592		
			Kanker	7,43,459		
			Rajnandgaon	12,61,892		
15	Chhattisgarh	Zone 15			63,82,828	57,44,545
			Bastar	13,52,402		
			Bijapur	58,602		
			Dantewada (South Bastar)	7,42,368		
			Dhamtari	7,35,608		
			Mahasamund	9,15,092		
			Narayanpur	59,580		
			Raipur	25,19,174		
16	Chhattisgarh	Zone 16			48,61,784	43,75,606
			Jashpur	8,50,758		
			Koriya	4,93,843		
			Raigarh	13,15,288		
			Surguja	22,01,896		
17	Chhattisgarh	Zone 17			39,94,360	35,94,924
			Bilaspur	18,13,993		
			Janjgir-Champa	14,06,534		
			Korba	7,73,832		
18	Haryana	Zone 18			35,26,319	31,73,687
			Ambala	7,88,860		
			Kaithal	9,15,179		
			Kurukshetra	7,31,932		
			Panchkula	3,12,019		
			Yamuna Nagar	7,78,330		
19	Haryana	Zone 19			56,74,876	51,07,388
			Bhiwani	13,85,555		
			Fatehgarh/Fatehabad	7,96,801		
			Hisar	13,66,799		
			Jind	11,37,900		
			Sirsa	9,87,821		
20	Haryana	Zone 20			45,18,011	40,66,210
			Jhajjar	8,21,970		
			Karnal	11,23,609		
			Panipat	6,90,443		
			Rohtak	7,32,629		
			Sonipat	11,49,360		
21	Haryana	Zone 21			45,10,811	40,59,730
			Faridabad	7,80,291		
			Gurgaon	6,73,003		

			Mahendragarh	8,43,462		
			Mewat	7,30,449		
			Palwal	7,28,593		
			Rewari	7,55,012		
22	Himachal Pradesh	Zone 22			17,44,666	15,70,199
			Kinnaur	94,001		
			Shimla	6,66,323		
			Sirmaur	4,93,108		
			Solan	4,91,234		
23	Himachal Pradesh	Zone 23			25,22,327	22,70,094
			Chamba	5,11,614		
			Kangra	15,20,094		
			Una	4,90,619		
24	Himachal Pradesh	Zone 24			23,11,790	20,80,611
			Bilaspur	3,82,721		
			Hamirpur	4,58,993		
			Kullu	4,21,774		
			Lahul & Spiti	39,869		
			Mandi	10,08,434		
25	Jammu & Kashmir	Zone 25			91,63,578	82,47,220
			Anantnag	11,92,684		
			Bandipora	2,30,466		
			Badgam	6,70,465		
			Baramulla	9,37,684		
			Doda	5,97,161		
			Ganderbal	1,59,327		
			Jammu	10,47,054		
			Kargil	1,30,380		
			Kathua	5,65,627		
			Kishtwar	14,261		
			Kulgam	12,202		
			Kupwara	7,49,878		
			Leh	1,06,312		
			Poonch	4,18,362		
			Pulwama	7,00,920		
			Rajouri	5,39,555		
			Ramban	1,61,659		
			Reasi	1,08,617		
			Samba	18,010		
			Shopian	11,103		
			Srinagar	1,48,210		
			Udhampur	6,43,642		
26	Jharkhand	Zone 26			40,78,312	36,70,480
			Gumla	10,47,730		
			Khunti	4,05,719		
			Lohardaga	3,81,990		

			Ranchi	17,62,972		
			Simdega	4,79,900		
27	Jharkhand	Zone 27			61,87,721	55,68,949
			Deoghar	12,06,647		
			Dumka	13,64,254		
			Godda	12,13,117		
			Jamtara	6,09,374		
			Pakur	7,98,762		
			Sahebganj	9,95,567		
28	Jharkhand	Zone 28			81,68,747	73,51,872
			Bokaro	11,67,606		
			Chatra	8,99,297		
			Dhanbad	13,70,093		
			Giridih	21,38,479		
			Hazaribagh	13,14,787		
			Koderma	4,95,185		
			Ramgarh	7,83,300		
29	Jharkhand	Zone 29			35,59,309	32,03,378
			Daltanganj (Palamu)	18,46,487		
			Garwah	11,91,390		
			Latehar	5,21,432		
30	Jharkhand	Zone 30			31,48,417	28,33,575
			Chaibasa(West Singhbhum)	13,92,131		
			East Singhbhum	10,70,141		
			Saraikela Kharsawan	6,86,146		
31	Madhya Pradesh	Zone 31			33,71,951	30,34,756
			Bhind	13,07,551		
			Morena	14,99,291		
			Sheopur	5,65,109		
32	Madhya Pradesh	Zone 32			43,84,828	39,46,345
			Ashok Nagar	2,03,639		
			Datia	5,88,829		
			Guna	13,70,706		
			Gwalior	7,78,921		
			Shivpuri	14,42,732		
33	Madhya Pradesh	Zone 33			64,59,126	58,13,213
			Dewas	11,39,851		
			Mandsaur	11,55,624		
			Neemuch	6,27,720		
			Ratlam	10,16,351		
			Shajapur	12,61,746		
			Ujjain	12,57,834		
34	Madhya Pradesh	Zone 34			83,18,305	74,86,475
			Badwani/Barwani	11,08,159		
			Dhar	17,42,574		

			Indore	8,82,557		
			Jhabua	15,28,236		
			Khandwa (East nimar)	10,34,218		
			Khargone	15,52,924		
			Burhanpur	4,69,638		
35	Madhya Pradesh	Zone 35			63,49,952	57,14,957
			Betul	13,63,267		
			Bhopal	4,32,950		
			Raisen	11,02,025		
			Raigarh	12,44,116		
			Sehore	10,62,206		
			Vidisha	11,45,388		
36	Madhya Pradesh	Zone 36			13,47,744	12,12,970
			Harda	4,47,899		
			Hoshangabad	8,99,845		
37	Madhya Pradesh	Zone 37			62,39,694	56,15,725
			Chhatarpur	13,80,514		
			Damoh	10,55,518		
			Panna	8,98,049		
			Sagar	17,17,296		
			Tikamgarh	11,88,318		
38	Madhya Pradesh	Zone 38			92,04,581	82,84,123
			Balaghat	15,64,795		
			Chhindwara	16,76,496		
			Dindori	6,64,632		
			Jabalpur	11,08,636		
			Katni	10,06,687		
			Mandla	9,62,786		
			Narsinghpur	9,65,443		
			Seoni	12,55,105		
39	Madhya Pradesh	Zone 39			75,80,873	68,22,786
			Anuppur	6,64,486		
			Rewa	19,83,292		
			Satna	17,81,461		
			Shahdol	7,48,092		
			Sidhi	9,67,657		
			Singrauli	9,16,488		
			Umaria	5,19,396		
40	Meghalaya	Zone 40			22,37,653	20,13,888
			East Khasi Hills	4,59,810		
			East Garo Hills	2,57,610		
			Jaintia Hills	3,28,861		
			Ri-Bhoi	2,15,532		
			South Garo Hills	1,10,804		
			West Garo Hills	5,51,294		

			West Khasi Hills	3,13,741		
41	Mizoram	Zone 41			5,37,080	4,83,372
			Aizawl	93,037		
			Champhai	79,612		
			Kolasib	35,353		
			Lawngtlai	88,344		
			Lunglei	95,120		
			Mamit	62,558		
			Saiha	49,476		
			Serchhip	33,580		
42	Punjab	Zone 42			18,82,546	16,94,291
			Gurdaspur	18,82,546		
43	Punjab	Zone 43			22,47,362	20,22,626
			Amritsar	12,55,493		
			Taran Taran	9,91,870		
44	Punjab	Zone 44			20,34,077	18,30,669
			Hoshiarpur	14,26,394		
			Nawanshahar	6,07,682		
45	Punjab	Zone 45			18,46,453	16,61,808
			Jalandhar	12,36,860		
			Kapurthala	6,09,593		
46	Punjab	Zone 46			20,71,354	18,64,218
			Fatehgarh Saheb	4,64,340		
			Ludhiana	16,07,014		
47	Punjab	Zone 47			23,44,710	21,10,239
			Patiala	8,94,524		
			Mohali	5,45,744		
			Rupnagar	9,04,441		
48	Punjab	Zone 48			16,98,425	15,28,582
			Sangrur	12,58,788		
			Barnala	4,39,637		
49	Punjab	Zone 49			16,53,444	14,88,100
			Mansa	6,55,595		
			Bhatinda	9,97,849		
50	Punjab	Zone 50			19,82,957	17,84,661
			Moga	8,59,457		
			Faridkot	4,28,785		
			Muktsar	6,94,715		
51	Punjab	Zone 51			15,54,458	13,99,013
			Ferozepur	15,54,458		
52	Rajasthan	Zone 52			1,16,78,070	1,05,10,263
			Alwar	30,69,184		
			Dausa	14,17,494		
			Jaipur	31,90,805		
			Jhunjhunu	18,22,288		
			Sikar	21,78,300		
53	Rajasthan	Zone 53			91,55,081	82,39,573
			Barmer	21,83,317		
			Jaisalmer	5,18,224		

			Jalore	16,06,735		
			Jodhpur	22,91,308		
			Pali	17,15,237		
			Sirohi	8,40,260		
54	Rajasthan	Zone 54			83,23,877	74,91,489
			Banswara	16,73,071		
			Chittorgarh	18,17,106		
			Dungarpur	12,32,144		
			Rajsamand	10,29,961		
			Udaipur	25,71,594		
55	Rajasthan	Zone 55			40,49,670	36,44,703
			Baran	10,19,566		
			Bundi	9,39,670		
			Jhalawar	12,14,497		
			Kota	8,75,938		
56	Rajasthan	Zone 56			60,20,940	54,18,846
			Bikaner	12,95,082		
			Churu	16,65,218		
			Hanumangarh	14,57,360		
			Sri Ganganagar	16,03,279		
57	Rajasthan	Zone 57			73,94,587	66,55,128
			Ajmer	15,68,393		
			Bhilwara	19,18,726		
			Nagaur	27,57,265		
			Tonk	11,50,204		
58	Rajasthan	Zone 58			53,29,151	47,96,236
			Bharatpur	20,30,618		
			Dholpur	9,67,968		
			Karauli	12,45,264		
			Sawai Madhopur	10,85,300		
59	Sikkim	Zone 59			5,77,177	5,19,459
			East District	2,30,626		
			North District	47,738		
			South District	1,53,095		
			West District	1,45,718		
60	Tripura	Zone 60			31,84,144	28,65,729
			Dhalai	3,46,801		
			North Tripura	6,33,893		
			South Tripura	8,55,952		
			West Tripura	13,47,498		
61	Uttar Pradesh	Zone 61			3,60,38,742	3,24,34,868
			Basti	23,62,595		
			Deoria	29,33,214		
			Gorakhpur	36,37,038		
			Hardoi	35,89,192		
			Kushi Nagar	33,12,808		
			Lakhimpur Kheri	34,34,034		
			Lucknow	15,92,248		
			Mahrajganj	24,75,934		
			Raebareli	21,92,425		

			Sant Kabir Nagar	15,83,610		
			Siddhartha Nagar	23,54,741		
			Sitapur	38,24,368		
			Unnao	27,46,537		
62	Uttar Pradesh	Zone 62			2,82,72,072	2,54,44,865
			Allahabad	44,75,184		
			Chandoli	17,63,632		
			Fatehpur	24,84,761		
			Gazipur	33,65,054		
			Jaunpur	43,46,722		
			Kaushambi	14,41,643		
			Mirzapur	21,95,443		
			Pratapgarh	31,03,943		
			Sant Ravidas Nagar	14,16,264		
			Sonbhadra	14,25,707		
			Varanasi	22,53,720		
63	Uttar Pradesh	Zone 63			1,88,60,236	1,69,74,212
			Badaun	30,14,748		
			Bahraich	25,71,689		
			Balrampur	18,56,124		
			Bareilly	29,12,567		
			Gonda	30,85,520		
			Pilibhit	16,21,151		
			Shahjahanpur	24,26,795		
			Shravasti	13,71,642		
64	Uttar Pradesh	Zone 64			2,10,48,099	1,89,43,289
			Ambedkar Nagar	22,14,940		
			Azamgarh	43,71,138		
			Balia	29,90,011		
			Barabanki	29,09,803		
			Chattrapati Shahuji Maharaj Nagar	18,03,386		
			Faizabad	21,69,186		
			Mau	17,92,354		
			Sultanpur	27,97,282		
65	Uttar Pradesh	Zone 65			1,63,71,628	1,47,34,465
			Auriya	12,13,231		
			Banda	15,51,979		
			Chitrakoot	8,27,598		
			Etawa	12,36,947		
			Farukhabad	14,74,637		
			Hamirpur	10,43,899		
			Jallou	13,36,711		
			Jhansi	12,39,805		
			Kannauj	13,88,341		
			Kanpur Dehat	17,46,683		
			Kanpur Nagar	16,44,586		
			Lalitpur	10,02,948		
			Mahoba	6,64,262		
66		Zone 66			1,48,56,598	1,33,70,938

			Bijnaur	28,44,322		
			Jyotiba Phule Nagar	13,57,057		
			Moradabad	31,76,750		
			Muzaffarnagar	31,67,376		
			Rampur	17,31,943		
			Saharanpur	25,79,149		
67	Uttar Pradesh	Zone 67			2,25,42,632	2,02,88,369
			Agra	24,63,272		
			Aligarh	25,53,110		
			Baghpat	11,21,471		
			Bulandshahar	26,86,397		
			Etah	24,09,418		
			Firozabad	17,16,486		
			Gautam Buddha Nagar	9,03,138		
			Ghaziabad	17,69,005		
			Hathras	12,85,861		
			Kashi Ram Nagar	3,58,678		
			Mainpuri	16,36,350		
			Mathura	17,84,992		
			Meerut	18,54,454		
68	Uttarakhand	Zone 68			19,74,125	17,76,712
			Dehradun	7,24,081		
			Rudraprayag	2,69,648		
			Tehri Garhwal	6,53,881		
			Uttarakashi	3,26,514		
69	Uttarakhand	Zone 69			32,94,590	29,65,131
			Almora	6,91,274		
			Bageshwar	2,89,991		
			Chamoli	3,83,587		
			Haridwar	12,01,094		
			Pouri Garhwal	7,28,644		
70	Uttarakhand	Zone 70			23,03,615	20,73,253
			Champawat	2,28,917		
			Nainital	5,92,631		
			Pitoragarh	4,82,947		
			Udham Singh Nagar	9,99,120		
71	Dadra & Nagar Haveli	Zone 71			2,04,032	1,83,629
			Dadra & Nagar Haveli	2,04,032		

** All population figures are based on Census 2001 data available with Registrar General of India (RGI). The 2010 figures are calculated after multiplying the 2001 population figures by an estimated multiplier of 1.2 (i.e. an estimated markup of 20%)*

-The population figures are estimated based on Census 2001 data. Actual population may differ from these figures.

ANNEXURE 6

ZONE WISE EMD AMOUNT

Zone Code	EMD Amount in INR (Rs.)
1.	8,35,000
2.	75,60,000
3.	56,25,000
4.	91,35,000
5.	1,08,40,000
6.	81,23,000
7.	72,00,000
8.	1,46,85,000
9.	93,10,000
10.	42,85,000
11.	73,45,000
12.	33,65,000
13.	63,90,000
14.	37,75,000
15.	50,80,000
16.	38,70,000
17.	31,80,000
18.	28,10,000
19.	45,15,000
20.	35,95,000
21.	35,90,000
22.	13,90,000
23.	20,10,000
24.	18,40,000
25.	72,95,000
26.	32,45,000
27.	49,25,000
28.	65,00,000
29.	28,35,000
30.	25,05,000
31.	26,85,000
32.	34,90,000
33.	51,40,000
34.	66,20,000
35.	50,55,000
36.	10,75,000
37.	49,65,000
38.	73,25,000

39.	60,35,000
40.	17,85,000
41.	4,30,000
42.	15,00,000
43.	17,90,000
44.	16,20,000
45.	14,70,000
46.	16,50,000
47.	18,70,000
48.	13,55,000
49.	13,20,000
50.	15,80,000
51.	12,40,000
52.	92,95,000
53.	72,85,000
54.	66,25,000
55.	32,25,000
56.	47,95,000
57.	58,85,000
58.	42,40,000
59.	4,60,000
60.	25,35,000
61.	2,86,75,000
62.	2,24,95,000
63.	1,50,10,000
64.	1,67,50,000
65.	1,30,30,000
66.	1,18,20,000
67.	1,79,35,000
68.	15,75,000
69.	26,25,000
70.	18,35,000
71.	1,65,000

ANNEXURE 7

Tentative Detailed Scope & Plan for Biometric Enrollment Services

The scope is to set up an enrolment station/camps for enrolment of residents of India and providing requisite MIS reports to Registrar and UIDAI on enrolments completed on a daily basis till the whole enrolment operation for the targeted population is completed. The functional scope shall also include the collection of demographic details as per the KYR+ data requirements of RGI. The Enrolling Agency shall also be responsible for delivering additional services as required by DOEACC.

PROCURE BIOMETRIC DEVICES AS PER UIDAI SPECIFICATIONS

The enrolling agency should procure digital camera and biometric devices (for fingerprint and iris capture), used for capture of biometric data at the enrolling station, which conform to UIDAI specifications and certified by UIDAI appointed agencies.

SETTING UP OF ENROLMENT STATIONS AND ENROLMENT CAMPS

The number of enrolment stations/camps and the duration shall be decided by the DOEACC taking into account a number of factors like population density, geographical and topographical features, accessibility etc. The minimum number of Enrolment Stations the Enrolment agency is expected to set up shall be based on

1. Population to be covered
2. Density of population and
3. Maximum distance between two camps

CONDUCT ENROLLMENT OPERATIONS AS PER STANDARD PROCESSES

Prior to the commencement of the Enrollment operations, the Enrollment Agency shall work closely with the local governing bodies. During the enrolment operation also publicity and awareness shall be done in coordination with the local authorities to encourage enrolment.

PRIVACY & SECURITY

Enrolling agencies are responsible to make sure that the data is kept in a very secure and confidential manner and under no circumstances, shall they neither use the data themselves nor part with the data to any other agency other than DOEACC. Mechanisms to ensure the same have to be put in place by the Enrolling agency and shall be subject to audit by DOEACC/RGI/UIDAI representative from time to time.

A stationary enrolment station in this context would mean an enrolment station that shall be available at a particular location and address for a period more than 10 days to complete enrolment of the population in the catchment area assigned. A mobile enrolment station in this context would mean an enrolment station housed in a mobile vehicle with facilities as defined in this section and shall move around in the catchment area (locality) assigned until the enrolment of the target population in the locality is completed. An enrolment station including a mobile

enrolment station shall be equipped with all the necessary machinery which include

S. No.	Enrolment Camp
1	Backup power supply (generator) of 2 KVA capacity for every five enrolment stations kept in a camp
2	Fuel to run the generators
3	Printed enrolment forms for filling data available in sufficient numbers
4	Adequate lighting, fans & power points for plugging various biometric devices available
5	Local authorities informed of enrolment schedule
6	Introducers informed of enrolment schedule
7	Banner for the Enrolment Centre placed at entrance
8	Posters depicting enrolment process in English & the local language present in visible places
9	Grievance handling Helpline Number and other important numbers displayed prominently inside/outside the enrolment centre
10	The User Manual of the software available for ready reference & operators aware of the same
11	Sponge for wetting and hand-cleaning cloth available

An enrolment camp shall be manned by a supervisor and technical personnel in addition to the operators at the enrolling stations. A ratio of 5:1 operators to supervisors as well as operators to technical staff subject to a minimum of one technical staff per one enrolment camp should be maintained by the Enrolment Agency. An area in the enrolment camp shall be clearly demarcated for enrollees waiting to be enrolled and facilities for seating should be provided. In case of mobile enrolment camps/stations, the decision on frequency/period of availability shall be decided by the DOEACC/RGI based on density of population, geographical terrain etc.

PROVIDE ELECTRONIC MIS REPORTS ON ENROLMENT STATUS DAILY:

Supervisor/ Operator shall update enrollment statistics on enrolment status to MIS of DOEACC on daily basis. The formats and contents of the MIS reports shall be decided by the DOEACC.

INTRODUCTION TO BIOMETRIC DEVICES

In NPR digitization, biometric will be captured for all those people having age greater than 5 years. The following details for each person will be captured using biometric devices:

- Photograph of all individuals
- Finger print of all ten fingers of individuals above 5 years of age
- IRIS of Individuals above 5 years of age

Detailed Guidelines for Collecting Biometric Data

i. **Fingerprint Capture**

a. **Left Hand Fingerprints:** The Enrollee should be requested to place all four fingers of the **left hand** to platen of the fingerprint scanner for the four-finger capture to ensure good contact and maximize the area of the captured fingerprints.

b. If **automatic** capture does not happen, the operator should force the capture through option available in the enrolment software. The capture software will allow forced capture only after at least one attempted automatic capture for that Enrollee.

c. The operator should visually check the image for quality and for typical problems. In case there are problems go back to steps above to retry the capture.

d. If capture is still not possible, move on to the next step to capture the fingerprints of the right hand.

e. **Right Hand Fingerprints:** The Enrollee should be requested to place all four fingers of the **Right Hand** to platen of the fingerprint scanner for the four-finger capture to ensure good contact and maximize the area of the captured fingerprints.

f. If **automatic** capture does not happen, the operator should force the capture through option available in the enrolment software. The capture software will allow forced capture only after at least one attempted automatic capture for that Enrollee.

g. Visually check the image for quality and for typical problems. In case there are problems go back to steps above to retry the capture.

h. If capture is still not possible, move on to the next step to capture the fingerprints of the two thumbs.

i. **Two Thumbs:** The Enrollee should be requested to place **Two Thumbs** to platen of the fingerprint scanner for the capture to ensure good contact and maximize the area of the captured fingerprints.

j. If **automatic** capture does not happen, the operator should force the



capture through option available in the enrolment software. The capture software will allow forced capture only after at least one attempted automatic capture for that Enrollee.

k. Visually check the image for quality and for typical problems. In case there are problems go back to steps above to retry the capture.

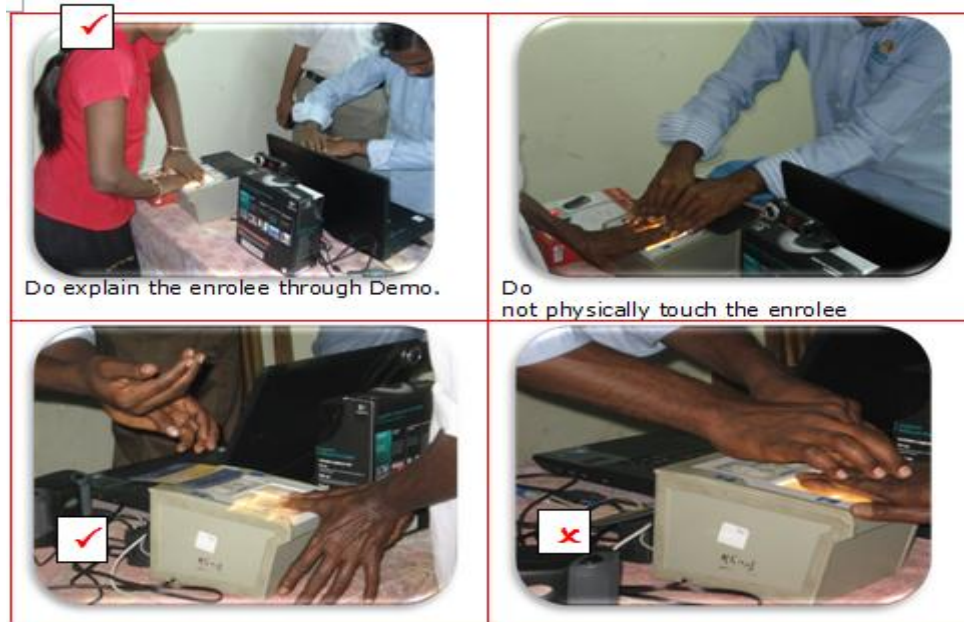

ii. Facial Image Capture

a. **Enrollee Position:** For capturing facial image, it is advisable for the operator to adjust the camera instead of the Enrollee to position herself/himself at the right distance or in the right posture.

b. **Focus:** The capture device should use auto focus and auto-capture functions. The output image should not suffer from motion blur, over or under exposure, unnatural colored lighting, and radial distortion. Interlaced video frames are not allowed.

c. **Expression:** Expression strongly affects the performance of automatic face recognition and also affects accurate visual inspection by humans. It is strongly recommended that the face should be captured with neutral (non-smiling) expression, teeth closed and both eyes open.

d. **Illumination:** Poor illumination has a high impact on the performance of face recognition. It is difficult for human operators to analyze and recognize face images with poor illumination. Proper and equally distributed lighting mechanism should be used such that there are no shadows over the face, no shadows in eye sockets, and no hot spots.

e. **Eye Glasses:** If the person normally wears glasses, it is recommended that the photograph be taken with glasses. However, the glasses should be clear and



transparent so that pupils and iris are visible. If the glasses are with tint, then direct and background lighting sources should be tuned accordingly.

- f. **Accessories:** Use of accessories that cover any region of the face is not permitted.
- g. However, accessories like eye patches are allowed due to medical reasons.
- h. Further, accessories like turban are also allowed as religious practices.
- i. Operators need to be trained to obtain the best possible face images that satisfy requirements.

iii. Iris Capture

a. Iris pattern of each eye is not correlated, and gives two independent biometric feature sets. It assures correct assignment of left and right eyes and allows for more accurate estimation of roll angle.

b. In order to obtain good quality template, the iris image diameter should be a minimum of 170 native pixels.

c. In order to retain sufficient image surrounding the iris for the purpose of identifying the left or right eye as well as for a more accurate iris segmentation, the margins around the iris portion of the image need to be at least 50% of the iris diameter on the left and right sides of the image, and a least 25% of the iris diameter on the top and bottom of the image.

d. The capture device should be more than 300 mm away from the Enrollee to be considered non-intrusive.

e. The capture device should use auto focus and auto-capture functions.

f. In special circumstances where the Enrollee has to position herself or himself, the capture device should be more than 100mm away but the device should use a visor or other mechanical alignment aid to enable the Enrollee to position themselves.

g. In order to provide an acceptable level of usability and ease of alignment, the camera must allow for some variability in the position of the iris centre relative to the camera. This variability is defined by position tolerances in the horizontal, vertical, and axial dimensions that together define a volume (the "capture volume") within which the centre of the iris must be located in order to enable image capture.

h. For two eye capture devices, the capture volume dimensions for devices without mechanical alignment aids are 19 mm wide, 14 mm high, and 20 mm deep, and for devices with such aids, 19 mm wide, 14 mm high, and 12 mm deep.



- i. The iris image capture device must be capable of capturing light in the range of 700 to 900 nanometers. The camera's near infrared illuminator(s) must have a controlled spectral content, such that the overall spectral imaging sensitivity, including the sensor characteristics, transfers at least 35% of the power per any 100 nm-wide sub-band of the 700 to 900 nm range.
- j. The iris image capture sensor shall use progressive scanning.
- k. Illumination shall be compliant with illumination standard IEC 825-1 and safety specification ISO 60825-1.
- l. In order to achieve acceptable recognition accuracy, the iris acquisition sensor must achieve a signal-to-noise ratio of at least 36dB.
- m. Within the frequency range of interest, 700 to 900 nm, the iris sensor shall generate images with at least 8 bits per pixel.
- n. The operator, not the Enrollee will handle the capture device.
- o. The Enrollee will be required to sit (or stand) in a fixed position, like taking a portrait photograph.
- p. The iris capture device or the connected computer would be able to measure the iris image quality. An initial image quality assessment would be done to provide feedback to the operator during the capture process. The device alerts the operator if the captured iris image is of insufficient quality.

The iris capture process is sensitive to ambient light. No direct or artificial light should directly reflect off Enrollee's eyes.

ANNEXURE 8

Format for Project Implementation Plan

1 Introduction

1.1 Purpose

[Describe the purpose of the plan and describes the project to be implemented]

1.2 Project Overview

[A description of the system to be implemented and its organization]

1.2.1 Project Description

[An overview of the services the project will provide the system]

1.2.2 Assumptions and Constraints

[Describes the assumptions made regarding the development and execution of this document as well as the applicable constraints]

1.2.3 Project Organization

[A description of the project organization structure and the major components essential to its implementation]

1.3 Glossary

[Lists all terms and abbreviations used in this plan]

2 Management Overview

[A description of how the implementation will be managed and identifies the major tasks involved]

2.1 Description of Implementation

[A description of the planned implementation approach]

2.3 Major Tasks

[Descriptions of the major project implementation tasks]

2.4 Implementation Schedule

[A schedule of activities to be accomplished]

2.5 Security and Privacy

[An overview of the security and requirements that must be followed during implementation]

2.5.1 Security Setup

[A description of the security setup to address the Confidentiality and Privacy concerns]

2.6 Data Backup & Restore procedure

[An overview of the data Backup & Restore Procedure that must be followed during implementation]

3 Implementation Support

3.1 Hardware, Software, Facilities, and Materials

[Lists all support hardware, software, facilities, and materials required for the implementation]

3.2 Documentation

[Lists any additional documentation needed to assist implementation]

3.3 Personnel

3.3.1 Staffing Requirements

[Describes the number of personnel, length of time needed, types of skills, skill levels, expertise, and their roles and responsibilities]

3.3.2 Training of Implementation Staff

[Describes the training necessary to prepare staff for taking up the task]

3.6 Performance Monitoring

[Describes the performance monitoring tool, techniques and how it will be used to help determine if the implementation is successful]

4 Implementation Requirements by Site

[Describes site-specific implementation requirements and procedures]

4.1 Site Name or Identification for Site X

[Identifies the site by name, location and ownership]

4.1.1 Site Requirements

[Describes the requirements that must be met for the orderly]

4.1.2 Site Implementation Details

[Description of the implementation team, schedule and processes required to accomplish the implementation at this site]

4.1.3 Risks and Contingencies

[Describes the risks and specific actions to be taken in the event the implementation fails]

4.1.4 Implementation Verification and Validation

[Describes the process for ensuring that task was not poorly executed]

4.2 Acceptance Criteria

[Describe the criteria that will be used to determine the acceptability of the deliverables]